

REV.	DATE	DESCRIPTION
NC	12/09/07	INITIAL RELEASE

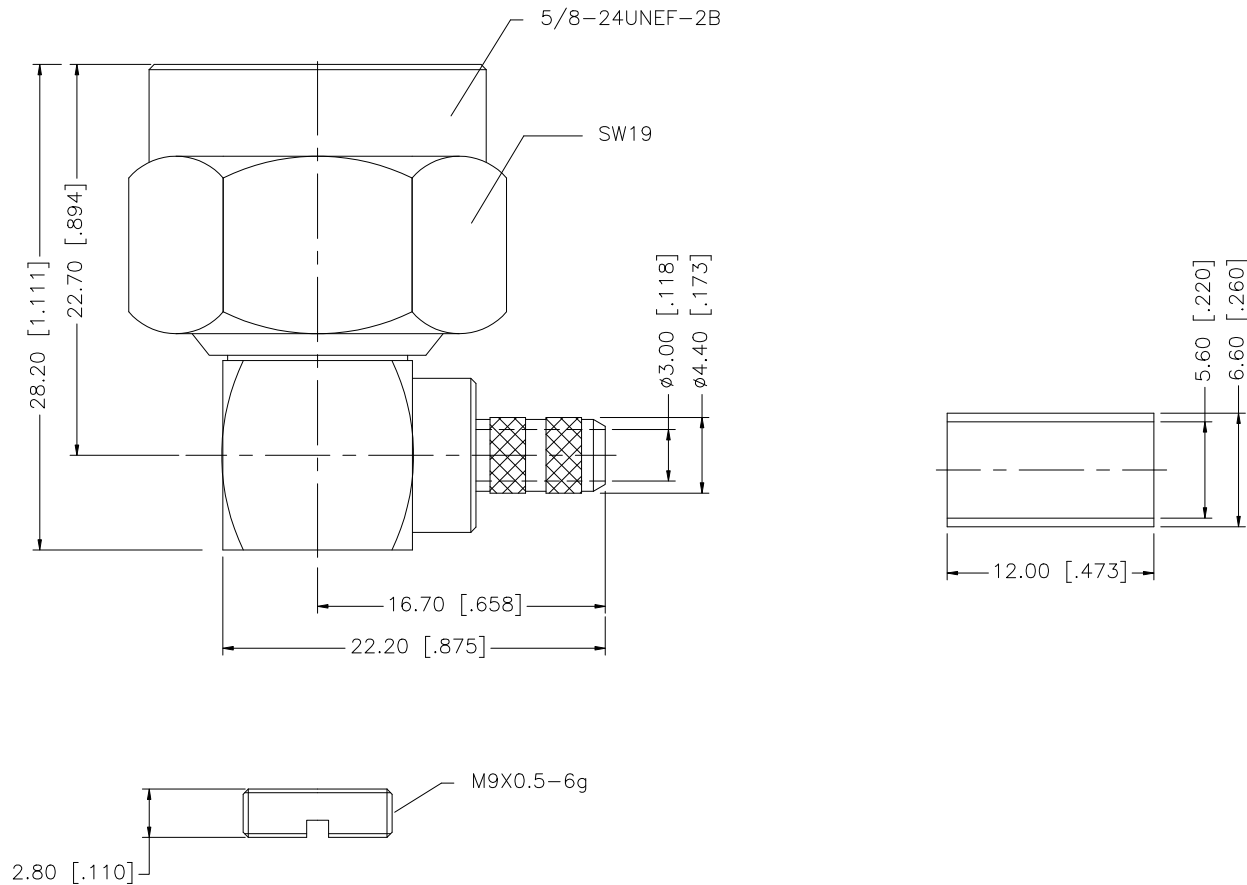

QTY	FINISH	MATERIAL	DESCRIPTION
1	NEXCOTE	BRASS	BODY/NUT
1	NATURAL	TEFLON	INSULATOR
1	SILVER	BRASS	CONTACT PIN
1	NEXCOTE	BRASS	CAP
1	NEXCOTE	COPPER	FERRULE

UNLESS OTHERWISE SPECIFIED DIMENSIONS ARE IN MILLIMETERS. DIMENSIONS IN [] ARE IN INCHES AND FOR CUSTOMER REFERENCE ONLY.

UNLESS OTHERWISE SPECIFIED TOLERANCES FOR MILLIMETERS ARE:
0.5 - 8mm ± 0.20mm
8 - 30mm ± 0.40mm
30 - 120mm ± 0.50mm

UNLESS OTHERWISE SPECIFIED TOLERANCES FOR INCHES ARE:
.020 - .315 = ± 0.007"
.315 - 1.180 = ± 0.015"
1.180 - 4.724 = ± 0.020"

DO NOT SCALE DRAWING

APPROVALS	DATE
DRAWN G.R.S.	12/09/07
CHECKED	
ISSUED	
SHEET 1 OF 1	
CAD FILE	C:/172/172178-11.DWG

Amphenol Connex

PART DESCRIPTION
**N R/A PLUG
FOR RG142/400-X1A**

PART NO.
172178-11

DWG. NO.	172178-11.DWG	REV.	NC	SIZE	A	SCALE	NA
----------	---------------	------	----	------	---	-------	----