

REV.	DATE	DESCRIPTION
NC	01/23/07	INITIAL RELEASE

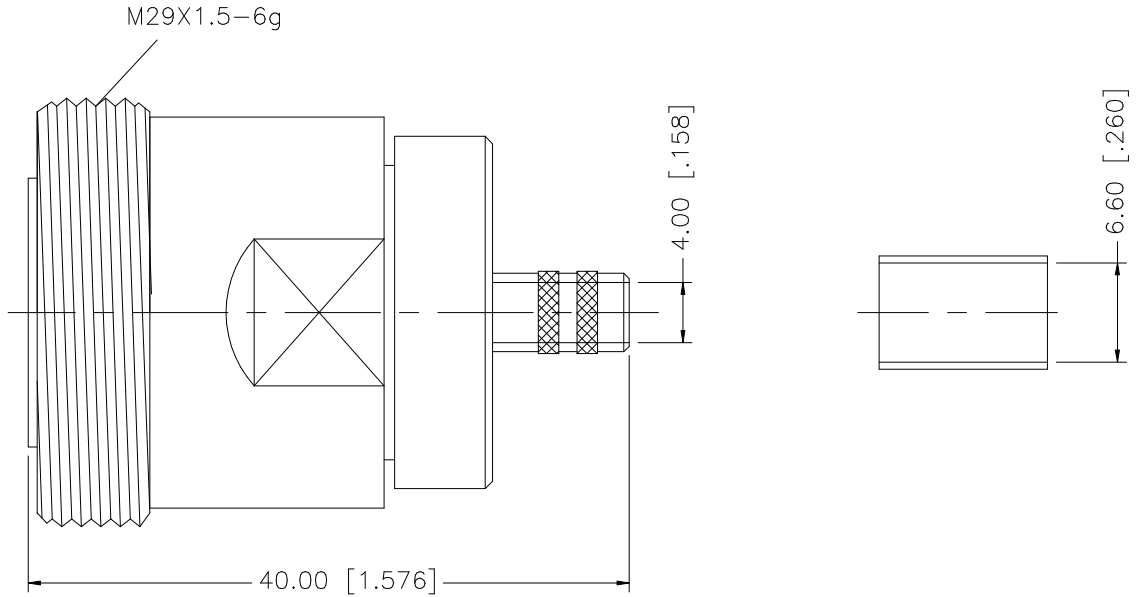

- NOTE:
1. REF: 7/16F-LMR240
  2. CRIMPED FERRULE HEX CRIMP SIZE .255"

REV.	DESCRIPTION	MATERIAL	FINISH	QTY	APPROVALS	DATE	<h1 style="color: blue; margin: 0;">Amphenol Connex</h1>
8							
7							
6							<b>727193</b>
5	NUT	BRASS	NEXCOTE	1			
4	O-RING	SILICONE	RED	1			<b>272193.DWG</b>
3	CONTACT PIN	BER. COPPER	SILVER	1			
2	INSULATOR	TEFLON	NATURAL	1			REV. NC    SIZE A    SCALE NA
1	BODY	BRASS	NEXCOTE	1			
UNLESS OTHERWISE SPECIFIED DIMENSIONS ARE IN MILLIMETERS. DIMENSIONS IN [ ] ARE IN INCHES AND FOR CUSTOMER REFERENCE ONLY. TOLERANCES FOR MILLIMETERS ARE: 0.5 - 8mm ± 0.20mm 8 - 30mm ± 0.40mm 30 - 120mm ± 0.50mm UNLESS OTHERWISE SPECIFIED TOLERANCES FOR INCHES ARE: .020 - .315 = ± 0.007" .315 - 1.180 = ± 0.015" 1.180 - 4.724 = ± 0.020"					DO NOT SCALE DRAWING		
					DRAWN G.R.S.	01/23/07	
					CHECKED		
					ISSUED		
					SHEET 1 OF 1		
					CAD FILE	C:/272/272193.DWG	
					DWG. NO.	272193.DWG	