

NOTES:

- DO NOT SCALE THIS DRAWING.
- MATERIAL AND FINISH:
 FEMALE CONTACT: BERYLLIUM COPPER, GOLD PLATED
 INSULATORS: TFE FLUOROCARBON
 OTHER METAL PARTS: BRASS, GOLD PLATED

102-245-01		REVISIONS		
DRAWING NO.	REV	DESCRIPTION	DATE	ECO
THIRD ANGLE PROJ.	A	OFFICIAL ENG. RELEASE TO MFG.	2/24/99	42858
				APPR PB/TA

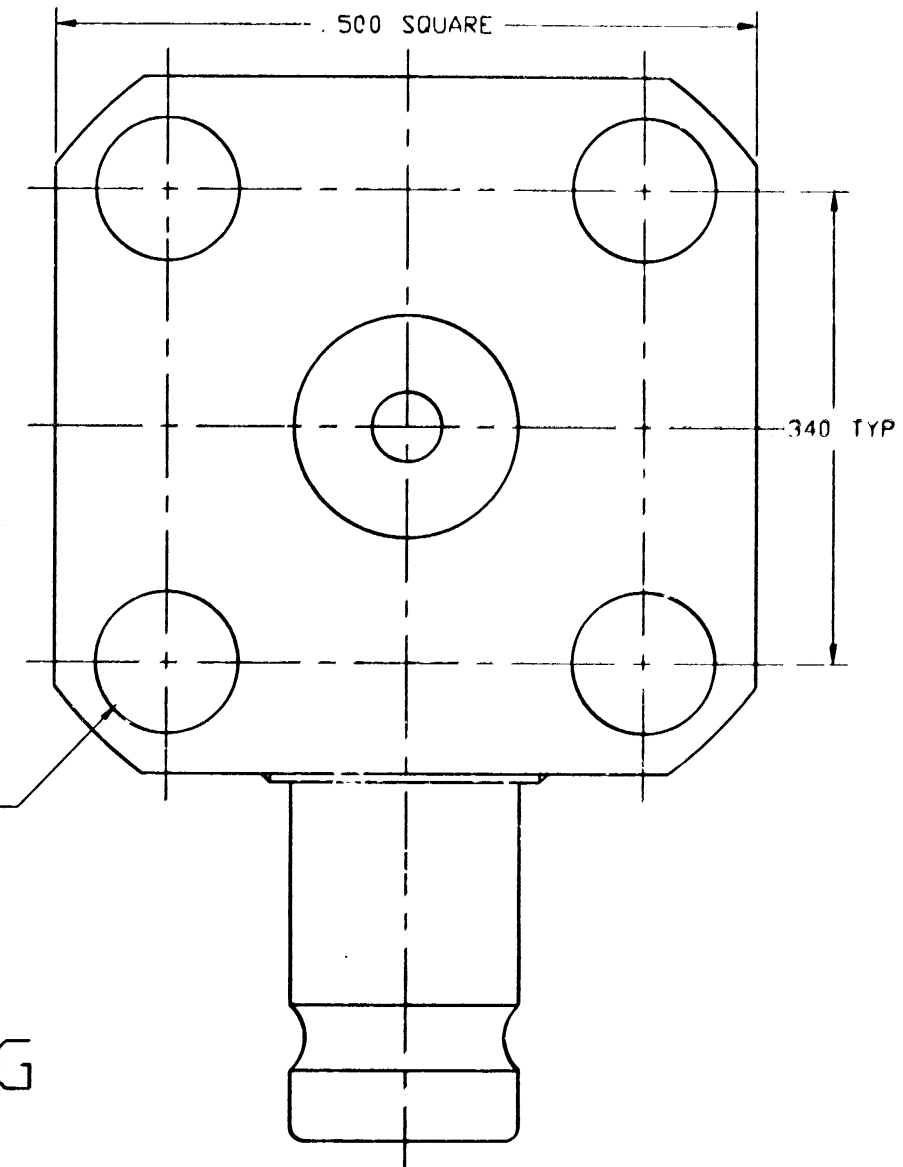
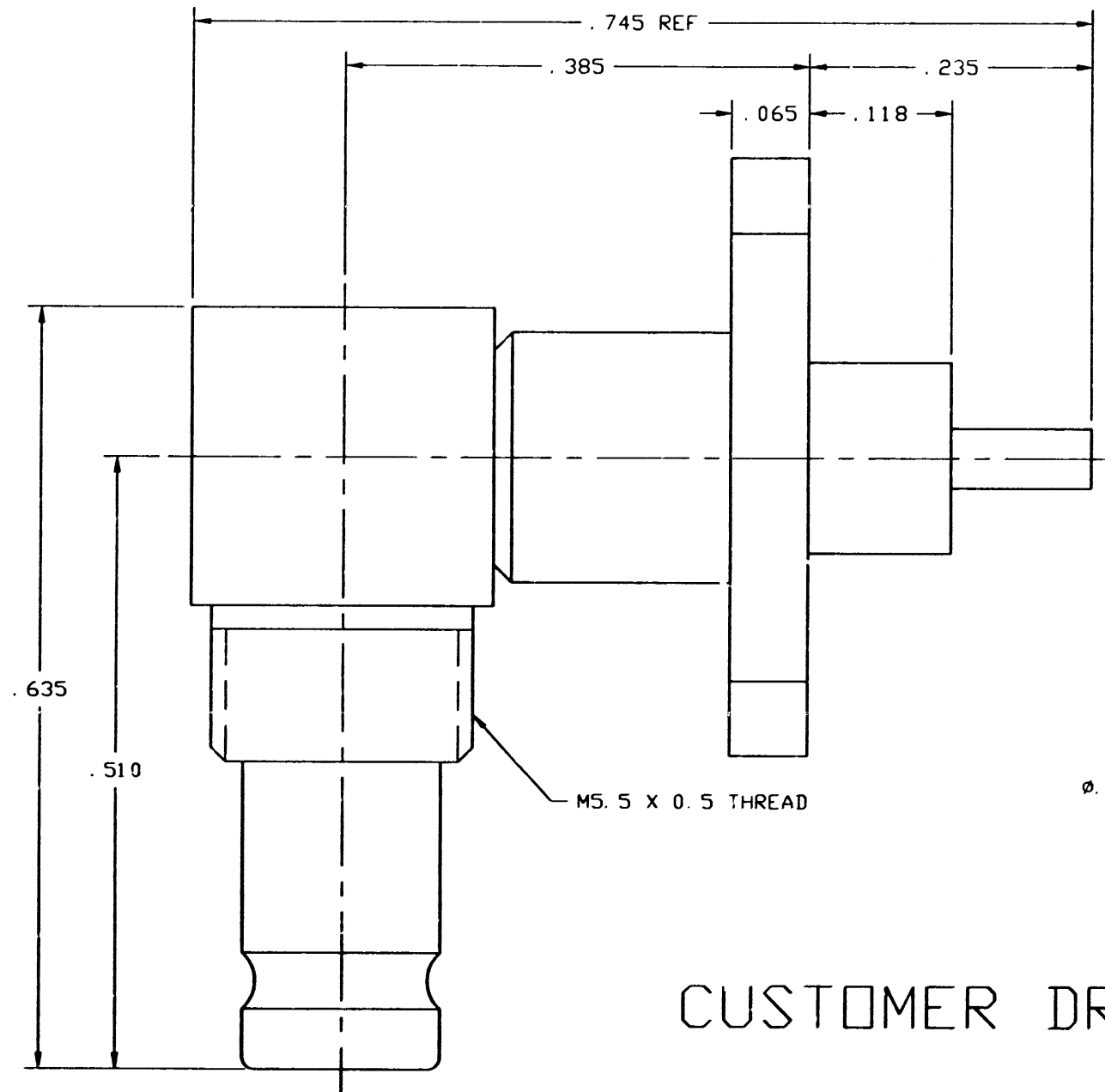

CUSTOMER DRAWING

UNLESS OTHERWISE SPECIFIED, DIMENSIONS ARE IN INCHES AND TOLERANCES ARE:
 2 PLACE DECIMAL ±.015 (0.381 mm)
 3 PLACE DECIMAL ±.005 (0.127 mm)
 ANGLES ± 1'

NOTICE - These drawings, specifications, or other data (1) are, and remain the property of Amphenol Corp. (2) must be returned upon request; and (3) are confidential and not to be disclosed to any person other than those to whom they are given by Amphenol Corp. The furnishing of these drawings, specifications, or other data by Amphenol Corp., or to any other person to anyone for any purpose is not to be regarded by implication or otherwise in any manner licensing, granting rights or permitting such holder or any other person to manufacture, use or sell any product, process or design, patented or otherwise, that may in any way be related to or disclosed by said drawings, specifications, or other data.

MATERIAL	DRAWN	DATE	TITLE
	P. BRENZEL	22 FEB 99	1.0/2.3 RIGHT ANGLE RECEPTACLE
REFERENCE	ENGINEER	DATE	
EAR 102-967115 1 SOCAPEX 102 ET 7310 01 SOCAPEX 102 245 01 615X-1519-100	P. BRENZEL	22 FEB 99	
	APPROVED	DATE	
	<i>[Signature]</i>	2/23/99	
	CAD FILE	CODE ID	DWG SIZE
	H:\PETEN\102\1023\ASSY\24501C	74868	B

DRAWN	DATE	TITLE
P. BRENZEL	22 FEB 99	1.0/2.3 RIGHT ANGLE RECEPTACLE
ENGINEER	DATE	
P. BRENZEL	22 FEB 99	
APPROVED	DATE	
<i>[Signature]</i>	2/23/99	
CAD FILE	CODE ID	DWG SIZE
H:\PETEN\102\1023\ASSY\24501C	74868	B

DRAWING NO.	DATE	ECO	APPR
102-245-01	2/24/99	42858	PB/TA

Amphenol	
Amphenol Corporation RF/Microwave Operations Danbury, Conn. U.S.A. 06810	
SCALE: 8:1	SHEET 2 OF 2
DRAWING NO.	ISSUE
102-245-01	A