

REV.	DATE	DESCRIPTION
NC	09/26/06	INITIAL RELEASE

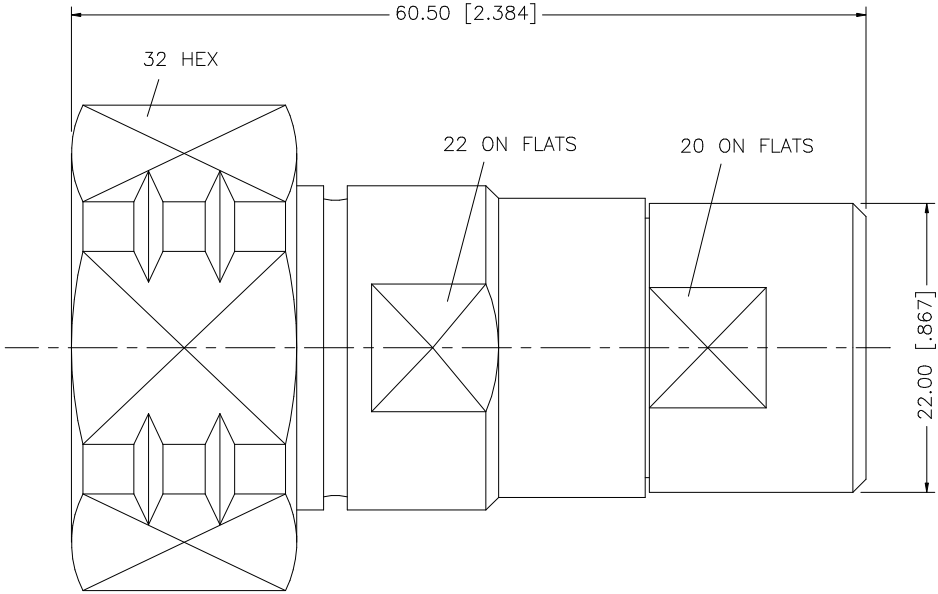

8				
7				
6				
5				
4	GASKET	SILICONE	RED	1
3	CONTACT PIN	BRASS	SILVER	1
2	INSULATOR	TEFLON	NATURAL	1
1	BODY	BRASS	NEXCOTE	1
	DESCRIPTION	MATERIAL	FINISH	QTY

UNLESS OTHERWISE SPECIFIED DIMENSIONS ARE IN MILLIMETERS. DIMENSIONS IN [ ] ARE IN INCHES AND FOR CUSTOMER REFERENCE ONLY.

UNLESS OTHERWISE SPECIFIED TOLERANCES FOR MILLIMETERS ARE:  
0.5 - 8mm ± 0.20mm  
8 - 30mm ± 0.40mm  
30 - 120mm ± 0.50mm

UNLESS OTHERWISE SPECIFIED TOLERANCES FOR INCHES ARE:  
.020 - .315 = ± 0.007"  
.315 - 1.180 = ± 0.015"  
1.180 - 4.724 = ± 0.020"

DO NOT SCALE DRAWING

APPROVALS	DATE
DRAWN G.R.S.	09/26/06
CHECKED	
ISSUED	
SHEET 1 OF 1	
CAD FILE	C:/272/272FPA4.DWG

<b>Amphenol Connex</b>			
PART DESCRIPTION 7/16 PLUG FOR 1/2" CORRUGATED (LDF) CABLE			
PART NO. 272FPA4.DWG			
DWG. NO.	272FPA4.DWG	REV. NC	SCALE NA