

REV.	DATE	DESCRIPTION
NC	10/05/07	INITIAL RELEASE

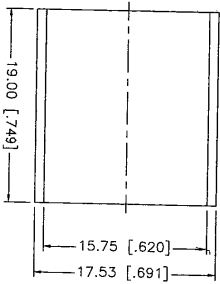
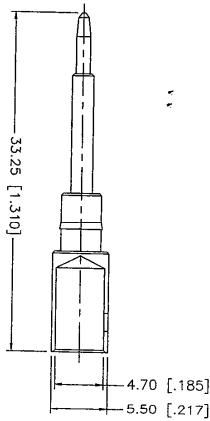
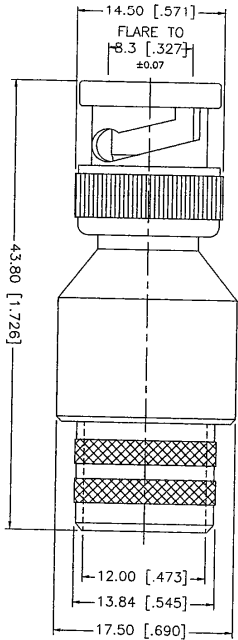
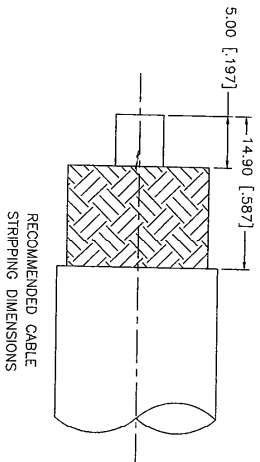

NOTE:
1. CRIMP INFORMATION: PLEASE CALL AMPHENOL CONNEX FOR CRIMP TOOL INFORMATION.

DESCRIPTION	MATERIAL	FINISH	QTY	DO NOT SCALE DRAWING	APPROVALS	DATE	PART RESERVATION	PART NO.	REV. NO.	REV. NC	SIZE A	SCALE NA
1	BRASS	NICKEL	1	1.180 - 4.724 = ± 0.020"	APPROVALS	10/05/07	Amphenol Connex	112742	112742.DWG			
2	INSULATOR	NATURAL	1	0.200 - 1.180 = ± 0.015"	DATE		BNC CRIMP PLUG					
3	CONDUCT PIN	GOLD	1	30 - 120mm ± 0.50mm	DATE		(FOR TIMES LMR-600)					
4	FERRULE	COPPER	1	8 - 30mm ± 0.20mm	DATE							
5				0.5 - 8mm ± 0.20mm	DATE							
6				INDICES STRIPPING SPECIFIC TO THIS DRAWING	DATE							
7				INDICES STRIPPING SPECIFIC TO THIS DRAWING	DATE							
8				INDICES STRIPPING SPECIFIC TO THIS DRAWING	DATE							
9				INDICES STRIPPING SPECIFIC TO THIS DRAWING	DATE							