

NOTES:

1. MATERIALS AND FINISHES:  
 BODY - STAINLESS STEEL, GOLD PLATING  
 CONTACT - BeCu, GOLD PLATING  
 INSULATOR & INSULATOR DISC - PTFE, NATURAL
2. ELECTRICAL:  
 A. IMPEDANCE: 50 OHM  
 B. FREQUENCY: DC - 18 GHz  
 C. VSWR: 1.20 MAX.  
 D. DIELECTRIC WITHSTANDING VOLTAGE: 750 VRMS, MIN.
3. MECHANICAL:  
 A. DURABILITY: 500 CYCLES MIN.  
 B. TEMPERATURE RANGE: -65°C TO +165°C

4. PACKAGING:  
 A. QUANTITY: SINGLE PACK  
 B. MARKING: PACKAGING TO BE MARKED  
 "AMPHENOL RF, 901-40134 DATE CODE"
5. CABLE ASSEMBLY INSTRUCTIONS:  
 A. TRIM CABLE AS SHOWN  
 B. SLIDE INSULATOR DISC OVER THE CABLE CENTER CONDUCTOR UNTIL BOTTOMING AGAINST CABLE OUTER CONDUCTOR.  
 C. ASSEMBLE CENTER CONTACT ONTO THE CABLE CENTER CONDUCTOR UNTIL FLUSH WITH THE INSULATOR DISC.  
 D. SOLDER CONTACT TO CABLE CENTER CONDUCTOR.  
 E. INSERT CABLE INTO CONNECTOR AND SOLDER OUTER CONDUCTOR OF CABLE TO BODY.

6 SHOWS CABLE ENTRY DIMENSIONS.

REVISIONS				
REV	DESCRIPTION	DATE	ECN	BY
A	RELEASE TO MFG.	20-JAN-26	17734	GSB

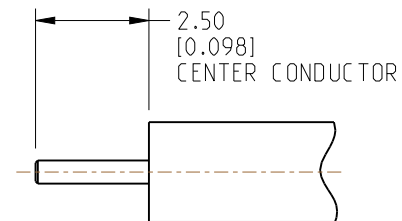

RECOMMENDED CABLE STRIPPING DIMENSION

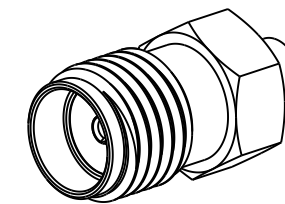

SCALE 3.000

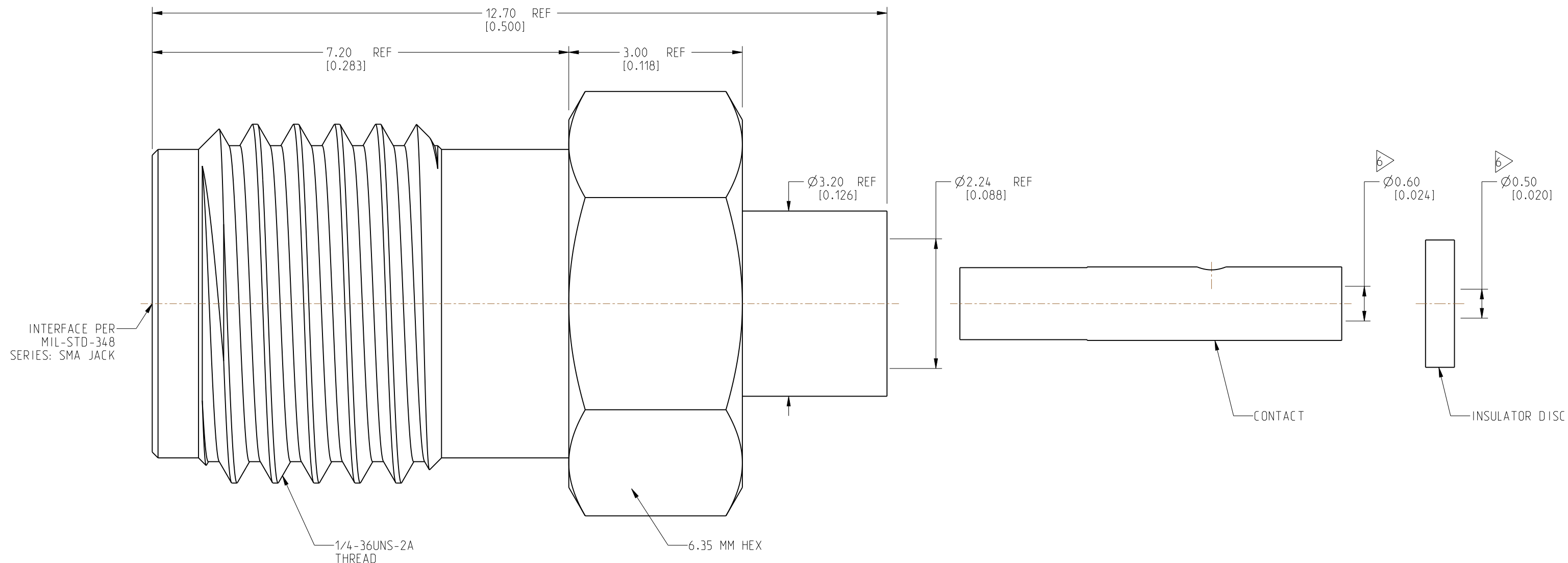

**CUSTOMER OUTLINE DRAWING**  
 ALL OTHER SHEETS ARE FOR INTERNAL USE ONLY

NOTICE: These drawings, specifications, or other data (1) are, and remain the property of Amphenol corp. (2) must be returned upon request; and (3) are confidential and not to be disclosed to any person other than those to whom they are given by Amphenol Corp. The furnishing of these drawings, specifications, or other data by Amphenol Corp., or to any other person to anyone for any purpose is not to be regarded by implication or otherwise in any manner licensing, granting rights to permitting such holder or any other person to manufacture, use or sell any product, process or design, patented or otherwise, that may in any way be related to or disclosed by said drawings, specifications, or other data.		UNLESS OTHERWISE SPECIFIED DIMENSIONS ARE METRIC (INCHES) AND TOLERANCES ARE: <0.5mm = ±0.05mm [ $<0.020 = \pm 0.002$ ] 0.5 - 6mm = ±0.1mm [ $0.020 - 0.236 = \pm 0.004$ ] >6.00 - 30mm = ±0.2mm [ $0.236 - 1.181 = \pm 0.008$ ] >30.00 - 120mm = ±0.3mm [ $1.181 - 4.725 = \pm 0.012$ ] ANGLES = ±1°		MATERIAL SEE NOTES		TITLE SMA STR JACK FOR 0.085" CABLE		Amphenol RF	
THIRD ANGLE PROJ.		REFERENCE SMA6181A4-3GT50G-0.085-50		ENGR.1 SURESH		ENGR.2 DATE 23-APR-25		SHEET NO. 2 OF 2 SCALE: 15.0:1.0	
EAR# 13007		DRAWING NO. 901-40134		ITEM NO. 901-40134		PART NO. 901-40134		REV A	