

NOTES:

1. MATERIALS & FINISHES:

- BODY
- CONTACT
- INSULATOR
- BRASS, GOLD PLATED
- BERYLLIUM COPPER, GOLD PLATED
- PTFE

2. ELECTRICAL:

- A. FREQUENCY RANGE
- B. V.S.W.R.
- C. D.W.V.
- D. INSULATION RESISTANCE
- = DC TO 6.0 GHz
- = 1.100 @ 2.5 GHz
- = 1,000 VRMS MIN.
- = 5,000 MEGOHMS MIN.

3. PHYSICAL:

- A. TEMPERATURE RANGE
- B. DURABILITY
- = -65°C TO +165°C
- = 500 MATING CYCLES MIN.

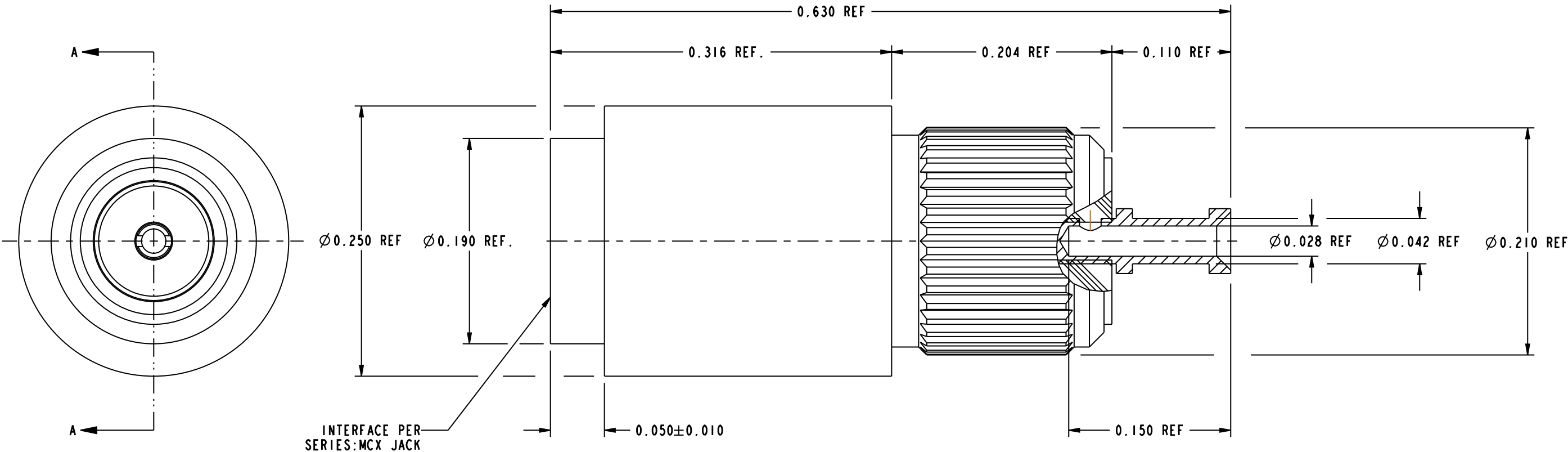
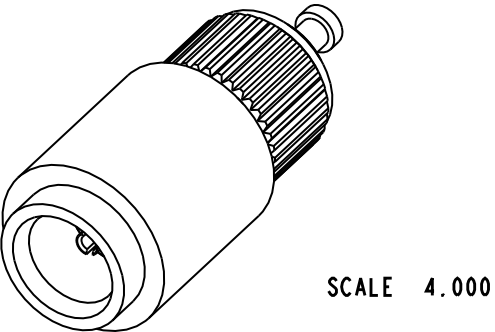
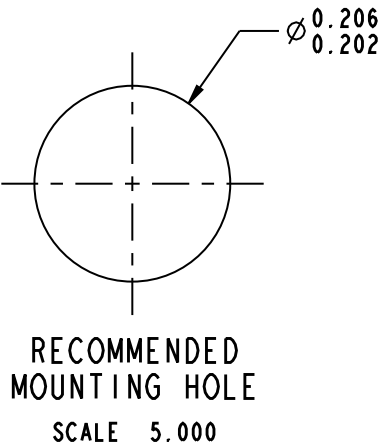

CUSTOMER OUTLINE DRAWING

ALL OTHER SHEETS ARE FOR INTERNAL USE ONLY

UNLESS OTHERWISE SPECIFIED, DIMENSIONS ARE IN INCHES AND TOLERANCES ARE: 2 PLACE DECIMAL ±.015 (0,381 mm) 3 PLACE DECIMAL ±.005 (0,127 mm) ANGLES ± 1°	MATERIAL	DRAWN B.C. GLEISSNER	DATE 9/14/01	TITLE  75 OHM MCX PRESS FIT BULKHEAD RECEPTACLE		Amphenol RF Danbury, CT, USA Tainan, Taiwan Shenzhen, China www.amphenolrf.com		
		ENGINEER G. ANTONINI	DATE 2/12/01					
NOTICE - These drawings, specifications, or other data (1) are, and remain the property of Amphenol Corp. (2) must be returned upon request; and (3) are confidential and not to be disclosed to any person other than those to whom they are given by Amphenol Corp. The furnishing of these drawings, specifications, or other data by Amphenol Corp., or to any other person to anyone for any purpose is not to be regarded by implication or otherwise in any manner licensing, granting rights or permitting such holder or any other person to manufacture, use or sell any product, process or design, patented or otherwise, that may in any way be related to or disclosed by said drawings, specifications, or other data.	REFERENCE REPLACES 919-157A-71S GEN# ASSYF16_MCX 615X-1709 EAR# 401	APPROVED O. BARTHELMES	DATE 7/18/02			SCALE: 10.0:1	SHEET	2 OF 2
		CAD FILE Root Folder/MCX/919-165A-71S		CODE ID 74868	DWG SIZE B	DRAWING NO. 919-165A-71S		REV C