

- NOTES:
- MATERIALS AND FINISHES:  
BODY - STAINLESS STEEL, PASSIVATED  
CONTACT - BERYLLIUM COPPER, GOLD PLATED  
INSULATOR - PTFE
  - ELECTRICAL:  
A. IMPEDANCE: 50 OHM
  - MECHANICAL:  
A. DURABILITY: 500 CYCLES MIN.  
B. TEMPERATURE RANGE: -65° C TO +165° C
  - PACKAGING:  
A. QUANTITY: SINGLE PACK  
B. MARKING: BAG TO BE MARKED  
"AMPHENOLRF, 901-10597, AND DATE CODE"

THIRD ANGLE PROJ. 

REVISIONS

REV	DESCRIPTION	DATE	ECN	APPR
A	RELEASE TO MFG.	27-Oct-17	05621	KCE
B	CONTACT UPDATED, .160" WAS .360"	02-Jan-18	06362	KCE

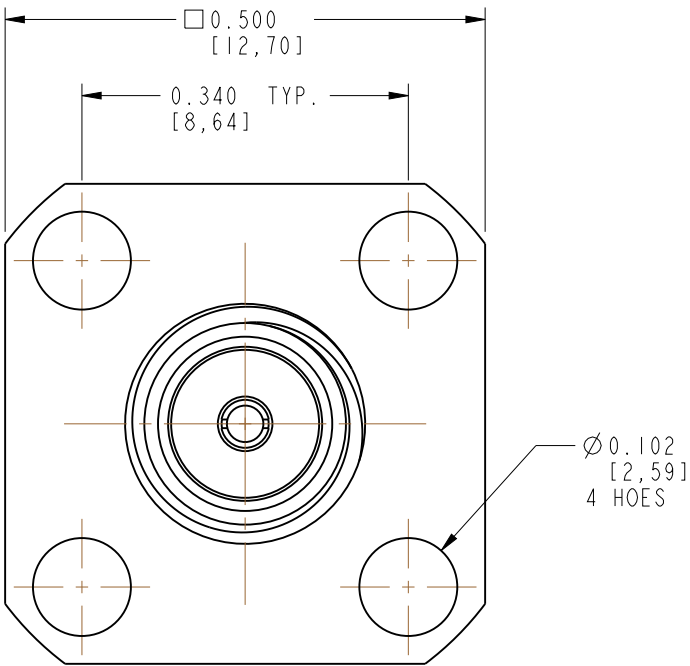
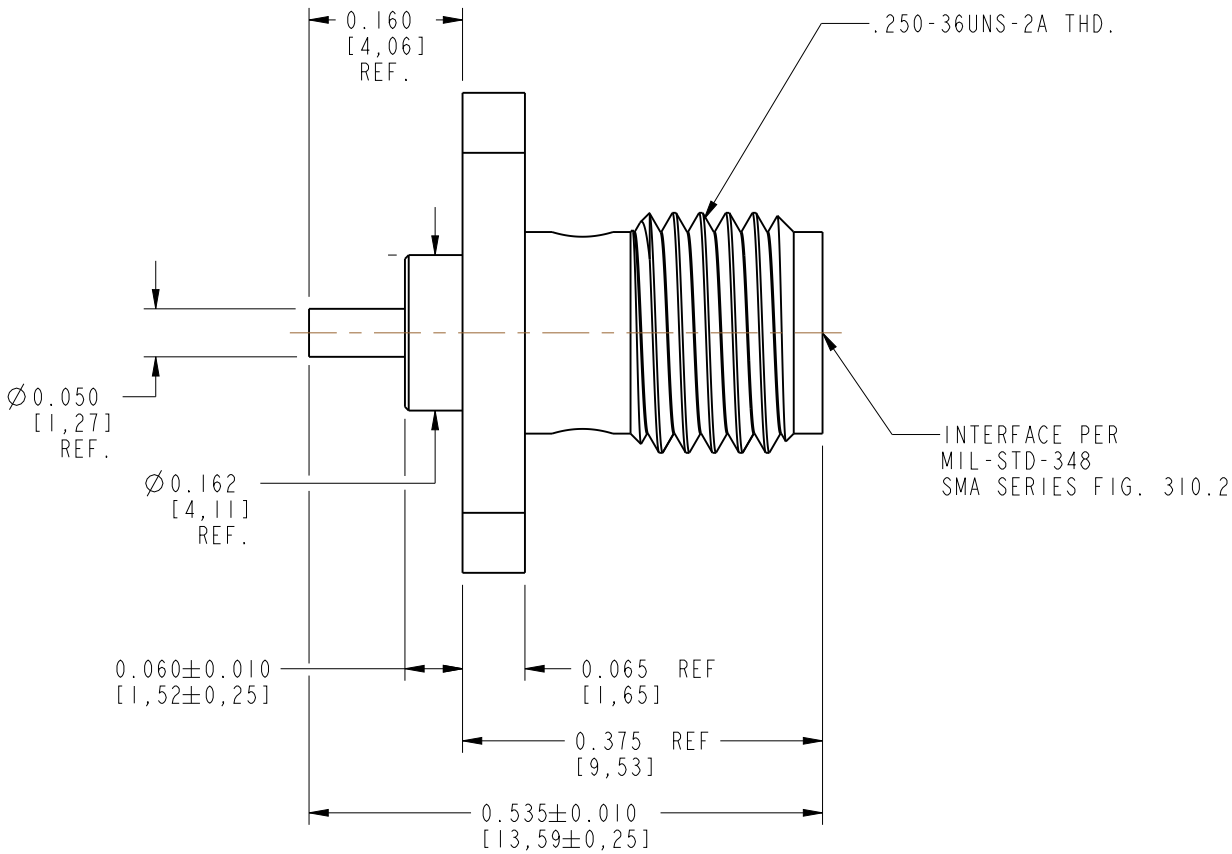
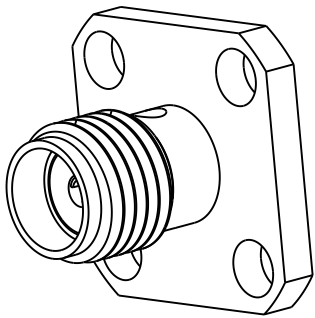

**CUSTOMER OUTLINE DRAWING**  
ALL OTHER SHEETS ARE FOR INTERNAL USE ONLY

UNLESS OTHERWISE SPECIFIED, DIMENSIONS ARE IN METRIC AND TOLERANCES ARE: <0.5mm      0.5 - 6mm      6 - 30mm      30 - 120mm      ANGLES ± 0.05mm    ±0.1mm      ±0.2mm      ± 0.3mm      ±1°  NOTICE - These drawings, specifications, or other data (1) are, and remain the property of Amphenol corp. (2) must be returned upon request; and (3) are confidential and not to be disclosed to any person other than those to whom they are given by Amphenol Corp. the furnishing of these drawings, specifications, or other data by Amphenol Corp., or to any other person to anyone for any purpose is not to be regarded by implication or otherwise in any manner licensing, granting rights to permitting such holder or any other person to manufacture, use or sell any product, process or design, patented or otherwise, that may in any way be related to or disclosed by said drawings, specifications, or other data.	MATERIAL		DRAWN	DATE	TITLE TYPE "SMA" PANEL JACK STRIPLINE CONNECTOR		Amphenol RF  www.amphenolrf.com	
	-		K. ELMES	03-Oct-17				
	REFERENCE		K. ELMES	03-Oct-17				
	EAR# 8019		APPROVED	DATE	SCALE: 5.0:1.0   SHEET 2 OF 2		DRAWING NO. 901-10597	
	REF:		K. CAPOZZI	27-Oct-17	DWG SIZE B		REV B	ITEM NO. 901-10597
	CONFIGURATION LEVEL: In Work		CAD FILE					PART NO. 901-10597
FINISH								