

- NOTES:
- MATERIALS AND FINISHES:
BODY - STAINLESS STEEL, PASSIVATED
CONTACT - BERYLLIUM COPPER, GOLD PLATED
INSULATOR - PTFE
 - ELECTRICAL:
A. IMPEDANCE: 50 OHM
 - MECHANICAL:
A. DURABILITY: 500 CYCLES MIN.
B. TEMPERATURE RANGE: -65° C TO +165° C
 - PACKAGING:
A. QUANTITY: SINGLE PACK
B. MARKING: BAG TO BE MARKED
"AMPHENOLRF, 901-10375, AND DATE CODE"

THIRD ANGLE PROJ.

REVISIONS

REV	DESCRIPTION	DATE	ECO	APPR
A	RELEASE TO MFG.	11/7/11	48833	JTS
B	0.402 WAS 0.410	11/15/11	48851	JTS

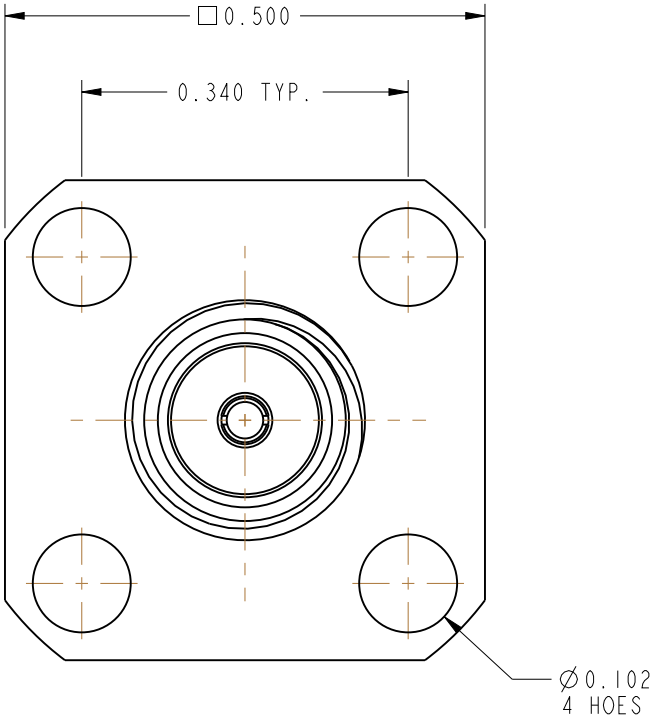
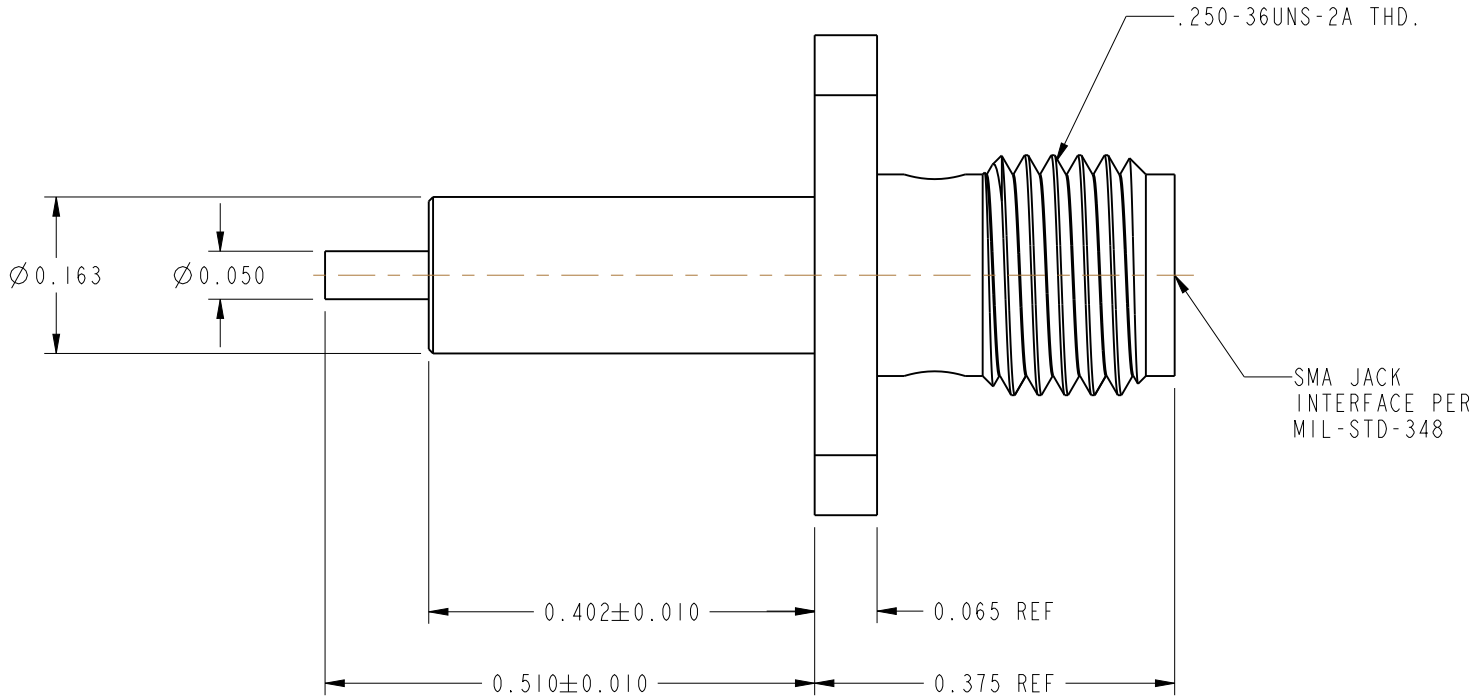
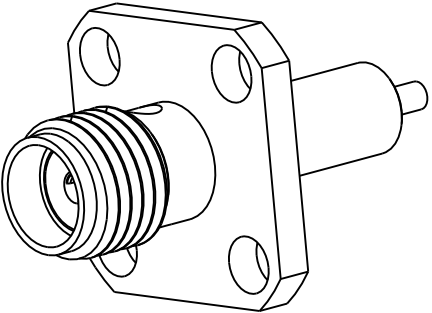

CUSTOMER OUTLINE DRAWING

ALL OTHER SHEETS ARE FOR INTERNAL USE ONLY

UNLESS OTHERWISE SPECIFIED, DIMENSIONS ARE IN METRIC AND TOLERANCES ARE: <0.5mm ± 0.05mm 0.5 - 6mm ± 0.1mm 6 - 30mm ± 0.2mm 30 - 120mm ± 0.3mm ANGLES ±1°	MATERIAL -	DRAWN T. SMITH	DATE 20-Oct-11	TITLE ASSEMBLY SMA, JACK		Amphenol RF	
		ENGINEER T. SMITH	DATE 20-Oct-11			www.amphenolrf.com	
	REFERENCE EAR #5009 AND	APPROVED O. BARTHELMES	DATE 10/28/11	SCALE: 5.0:1.0	SHEET 2 OF 2	DRAWING NO.901-10375	
	CONFIGURATION LEVEL: In Work	CAD FILE		DWG SIZE B	REV B	ITEM NO.901-10375	
NOTICE - These drawings, specifications, or other data (1) are, and remain the property of Amphenol corp. (2) must be returned upon request; and (3) are confidential and not to be disclosed to any person other than those to whom they are given by Amphenol Corp. the furnishing of these drawings, specifications, or other data by Amphenol Corp., or to any other person to anyone for any purpose is not to be regarded by implication or otherwise in any manner licensing, granting rights to permitting such holder or any other person to manufacture, use or sell any product, process or design, patented or otherwise, that may in any way be related to or disclosed by said drawings, specifications, or other data.	FINISH					PART NO.901-10375	