

- NOTES:
1. MATERIALS AND FINISHES:  
BODY - STAINLESS STEEL, GOLD PLATING  
CONTACT - BERYLLIUM COPPER, GOLD PLATING  
INSULATOR - PTFE
2. ELECTRICAL:  
A. IMPEDANCE: 50 OHM
3. MECHANICAL:  
A. DURABILITY: 500 CYCLES MIN.  
B. TEMPERATURE RANGE: -65° C TO 165° C
4. PACKAGING:  
A. QUANTITY: SINGLE PACK  
B. MARKING: BAG TO BE MARKED  
"AMPHENOL RF,901-3348, AND DATE CODE"

5> SHOWS CABLE ENTRY DIMENSIONS .

901-3348		REVISIONS			
DRAWING NO.	REV	DESCRIPTION	DATE	ECO	APPR
THIRD ANGLE PROJ.	--	RELEASE TO MFG	--	--	--
	N	SEE SHEET 1	10/27/09	47814	KR

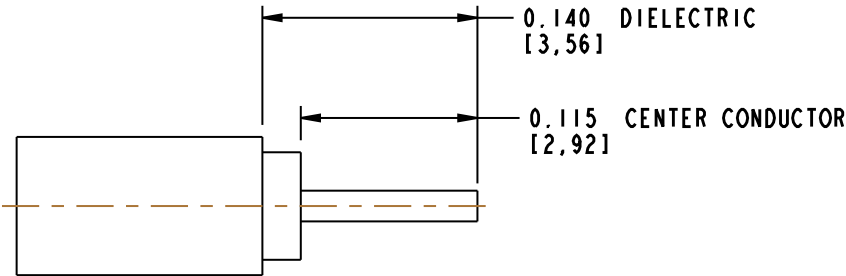

SCALE 8.000

**RECOMMENDED CABLE STRIPPING DIMENSIONS**

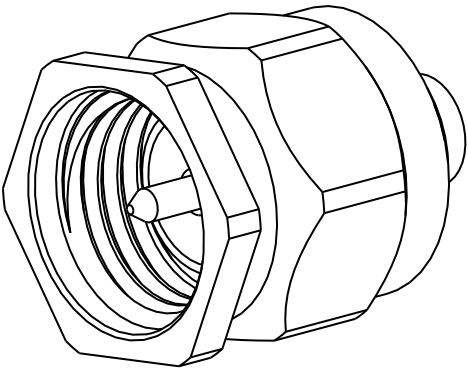

SCALE 5.000

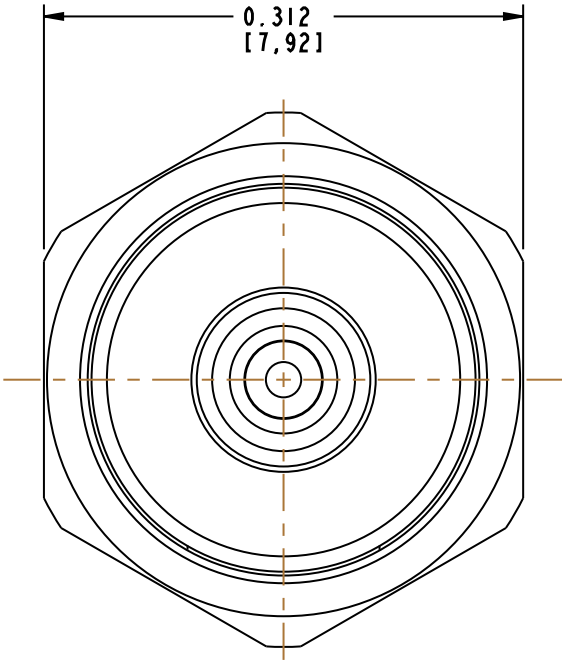
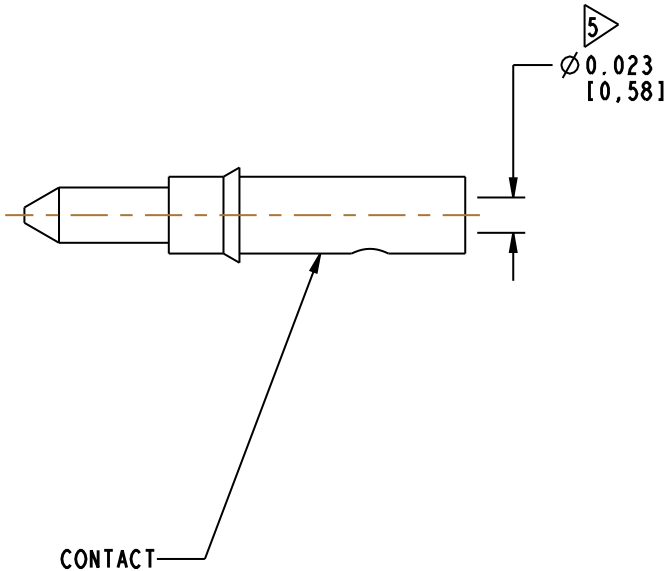
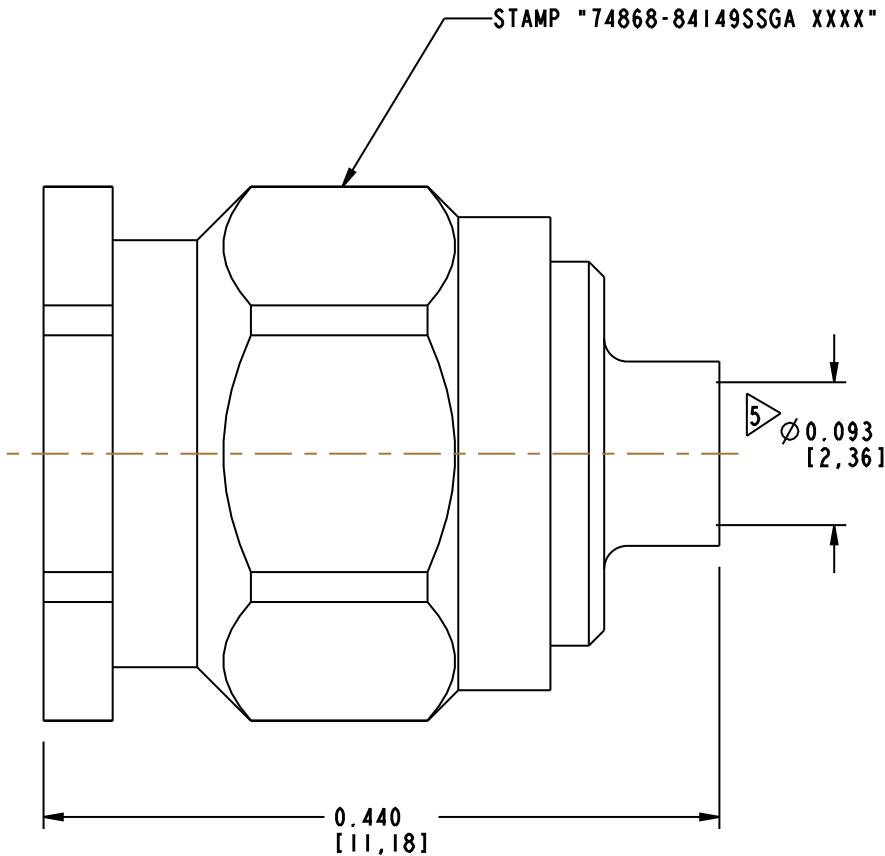

**CUSTOMER OUTLINE DRAWING**  
ALL OTHER SHEETS ARE FOR INTERNAL USE ONLY

UNLESS OTHERWISE SPECIFIED, DIMENSIONS ARE IN INCHES AND TOLERANCES ARE: 2 PLACE DECIMAL      3 PLACE DECIMAL      ANGLES ±.015 (0,381 mm)      ±.005 (0,127 mm)      ± 1°	MATERIAL SEE NOTES	DRAWN KARTHIK.R	DATE 24-Sep-09	TITLE SMA PLUG SOLDER TYPE FOR .085 CUJAK CABLE			Amphenol RF Danbury, CT, USA Tainan, Taiwan Shenzhen, China www.amphenolrf.com		
		ENGINEER O.MCPHERSON	DATE 03-Aug-07						
NOTICE - These drawings, specifications, or other data (1) are, and remain the property of Amphenol Corp. (2) must be returned upon request; and (3) are confidential and not to be disclosed to any person other than those to whom they are given by Amphenol Corp. The furnishing of these drawings, specifications, or other data by Amphenol Corp., or to any other person to anyone for any purpose is not to be regarded by implication or otherwise in any manner licensing, granting rights or permitting such holder or any other person to manufacture, use or sell any product, process or design, patented or otherwise, that may in any way be related to or disclosed by said drawings, specifications, or other data.	REFERENCE EAR 111-98916 DESC 84149SSGA	APPROVED K. CAPOZZI	DATE 10/27/09	SCALE: 8.0:1			SHEET 2 OF 2		
		CAD FILE Root Folder/SMA/901-3348							CODE ID 74868