

NOTES:

1. MATERIALS OF CONSTRUCTION:  
BODY - BRASS, GOLD PLATED.  
CONTACT - BERYLLIUM COPPER, GOLD PLATED.  
INSULATOR - TFE FLUOROCARBON.  
COMPLIANT PINS - PHOSPHOR BRONZE, TIN PLATED.  
BODY SHROUD - BRASS, GOLD PLATED.
2. PERFORMANCE:  
IMPEDANCE - 50 Ohm  
INS RESISTANCE - 5,000 MOhm  
DWV - 1,000 VRMS  
OPERATING TEMP. - -40° TO +85° C  
SOLDERABILITY - PER MIL-STD-202, METHOD 208
3. INSTALL CONNECTOR INTO PCB USING TOOL: MET 7004 06
4. DO NOT SCALE THIS DRAWING.

901-144-PFD

REVISIONS

DRAWING NO.	REV	DESCRIPTION	DATE	ECO	APPR
THIRD ANGLE PROJ.	A	RELEASED TO MFG.	3/10/99	42869	CPM/
	B	Ø.039 WAS 4 HOLES	3/19/10	47982	CPM/

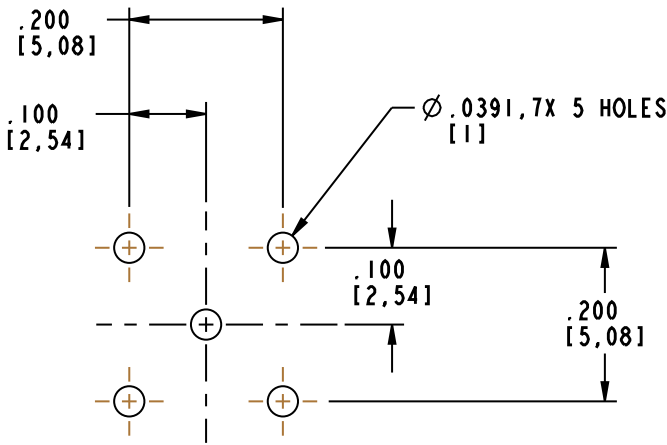
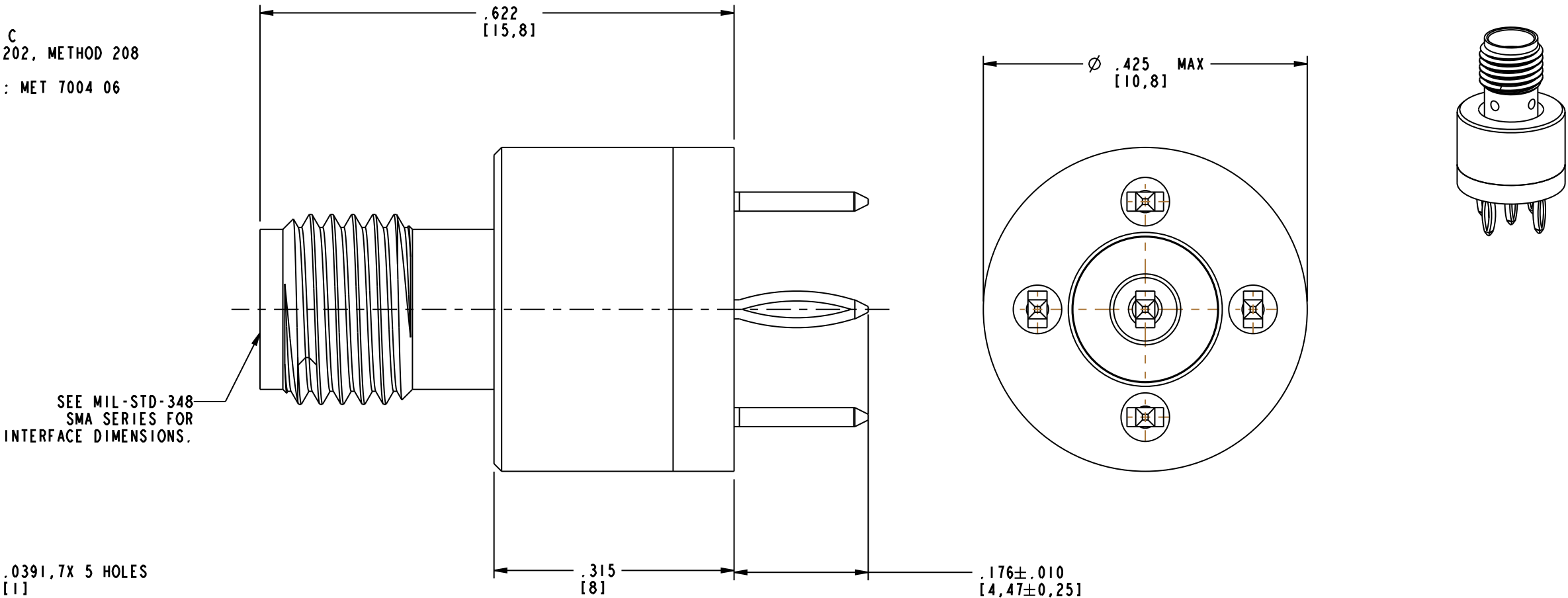

RECOMMENDED MOUNTING HOLE  
SCALE 4.000

**CUSTOMER OUTLINE DRAWING**  
ALL OTHER SHEETS ARE FOR INTERNAL USE ONLY

UNLESS OTHERWISE SPECIFIED, DIMENSIONS ARE IN INCHES AND TOLERANCES ARE: 2 PLACE DECIMAL 3 PLACE DECIMAL ANGLES ±.015 (0,381 mm) ±.005 (0,127 mm) ± 1°	MATERIAL	DRAWN C. McGRATH	DATE 2/23/99	TITLE PRESS FIT SMA CONNECTOR		Amphenol RF Danbury, CT, USA Tainan, Taiwan Shenzhen, China www.amphenolrf.com		
		ENGINEER F. ORBETA	DATE 2/23/99					
		APPROVED T. AUBIN	DATE 3/10/99					
		CAD FILE I:\SMA\901-144-PFD	CODE ID 74868					
NOTICE - These drawings, specifications, or other data (1) are, and remain the property of Amphenol Corp. (2) must be returned upon request; and (3) are confidential and not to be disclosed to any person other than those to whom they are given by Amphenol Corp. The furnishing of these drawings, specifications, or other data by Amphenol Corp., or to any other person to anyone for any purpose is not to be regarded by implication or otherwise in any manner licensing, granting rights or permitting such holder or any other person to manufacture, use or sell any product, process or design, patented or otherwise, that may in any way be related to or disclosed by said drawings, specifications, or other data.	REFERENCE EAR #967190-0 GEN #ASSYF24_SMA			SCALE: 6.0:1		SHEET 1 OF 1		