

NOTES:

1. MATERIALS AND FINISHES:  
BODY = BRASS, TIN PLATED  
CONTACT = PHOSPHOR BRONZE, TIN PLATED  
INSULATOR = POLYPROPYLENE

531-40046-3

## REVISIONS

DRAWING NO.

REV

DESCRIPTION

DATE \_\_\_\_\_

ECO	APPR
-----	------

THIRD ANGLE PROJ.

A

RELEASE TO MFG.

6 / 28 / 0

43782 | CPM/

B	SEE SHEET 1
---	-------------

7/11/0

43787	CPM/
-------	------

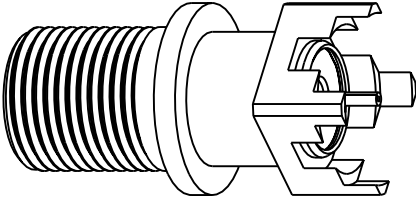

SCALE 2.000

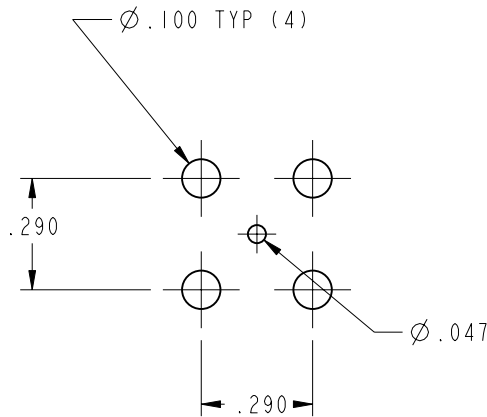

RECOMMENDED  
MOUNTING HOLE  
SCALE 2.000

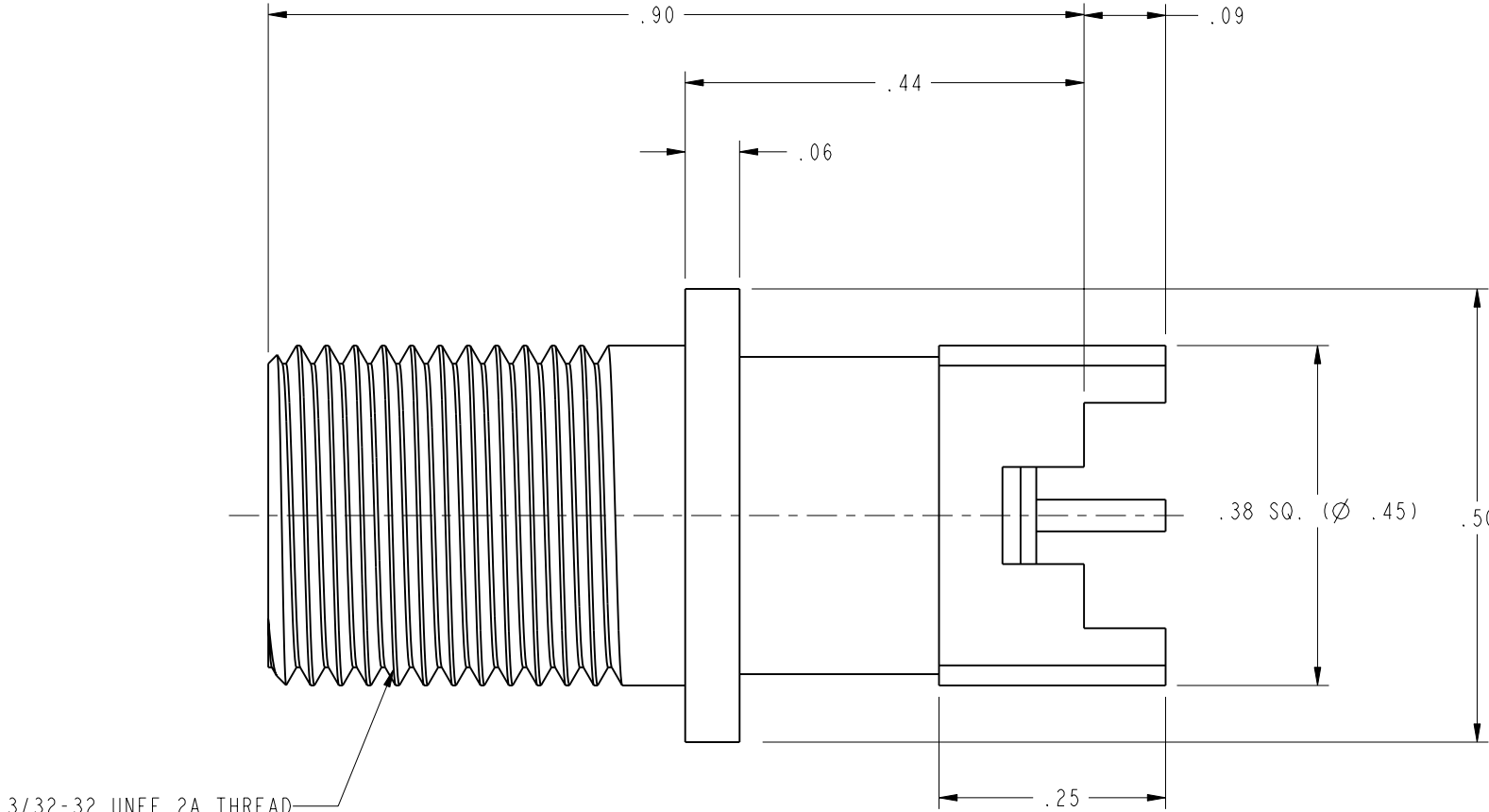

# CUSTOMER OUTLINE DRAWING

ALL OTHER SHEETS ARE FOR INTERNAL USE ONLY

UNLESS OTHERWISE SPECIFIED, DIMENSIONS ARE IN INCHES AND TOLERANCES ARE

2 PLACE DECIMAL	3 PLACE DECIMAL	ANGLES
±.015 (0,381 mm)	±.005 (0,127 mm)	± 1°

MATERIAL

DRAWN

DATE \_\_\_\_\_

C. McGRATH

6/27/01

ENGINEER  
O. BARTHELMES

DATE  
6/27/01

T I T L E

'F' FEMALE  
STRAIGHT PCB  
(MACHINED BODY)

Amphenol

Amphenol Corporation  
Communication and Network  
Products Division  
Danbury, CT U.S.A. 06810

SCALE: 5.0:1	SHEET 2 OF 2
--------------	--------------

CAD FILE  
I:\CATV\FTYPE\53I-40046-1

CODE ID  
74868

B

DRAWING NO

531-40046-3

EV

B