

1. MATERIALS AND FINISHES:
 - BODY - BRASS, GOLD PLATING
 - REAR-BODY & NUT - BRASS, NICKEL PLATING
 - CONTACT - BeCu, GOLD PLATING
 - LEGS - PHOSPHOR BRONZE, TIN PLATING
 - INSULATOR - PTFE, NATURAL
 - ISOLATING WASHER - MYLAR, WHITE
2. ELECTRICAL:
 - A. IMPEDANCE: 50 OHM
 - B. FREQUENCY RANGE: DC-10 GHz
3. MECHANICAL:
 - A. DURABILITY: 500 CYCLES MIN.
 - B. TEMPERATURE RANGE: -40° C TO 155° C
 - C. FORCE TO ENGAGE: 540N MAX.(FOR PCB ASSEMBLY)
 - D. FORCE TO DISENGAGE: 90N MIN.(FOR PCB ASSEMBLY)
4. THE PCB BOARD THICKNESS IS 3MM MAX.
5. PACKAGING:
 - A. QUANTITY: 200 PCS IN TRAY PACK
 - B. MARKING: BAG TO BE MARKED
"AMPHENOL RF, 102-811-03, AND DATE CODE"
 - C. SPANNER NUT IS PACKAGED LOOSE.

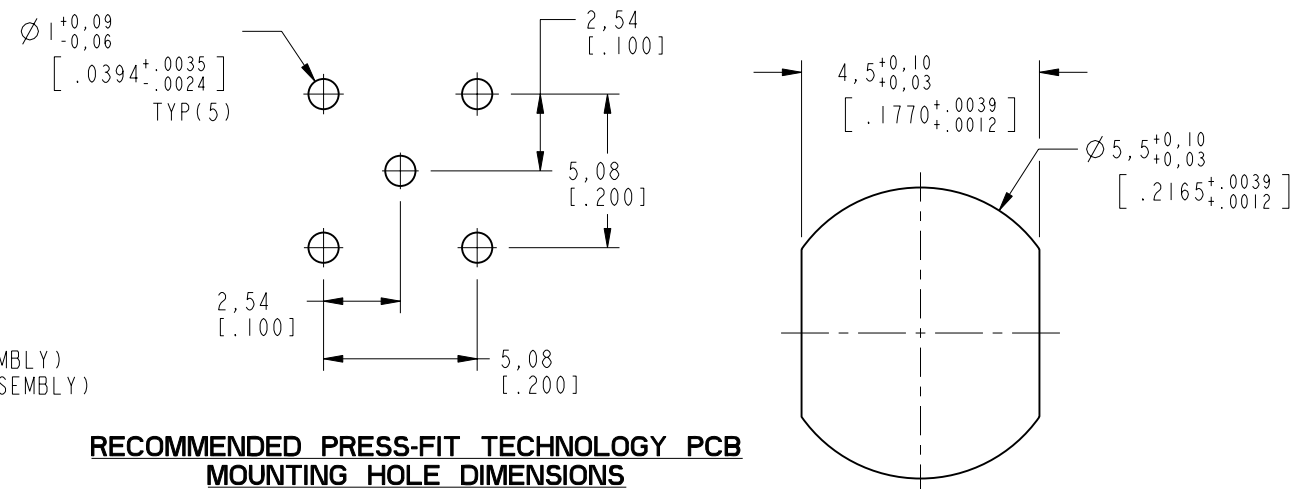

RECOMMENDED PRESS-FIT TECHNOLOGY PCB MOUNTING HOLE DIMENSIONS

RECOMMENDED MOUNTING HOLE DIMENSIONS

REVISIONS				
REV	DESCRIPTION	DATE	ECO	APPR
A	RELEASE TO MFG	21-Sep-00	43512	CPM
B	LEGS WERE TIN/LEAD PLATE	27-Jun-05	45598	CPM
C	THE PLATING OF BODY, CONTACT PIN & LEG WERE CHANGED / RD-DA05050501L	05-May-05	--	--
D	LEG WAS CHANGED / RD-DA07020801E	15-Feb-15	--	--
E	REDRAWN IN PRO-E & SYNCH THE DRAWING	29-Oct-15	50665	MJD

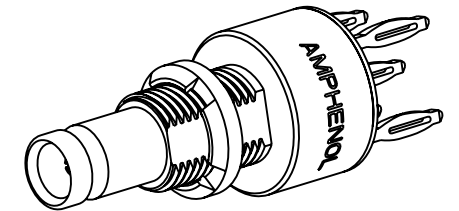

SCALE 2.500

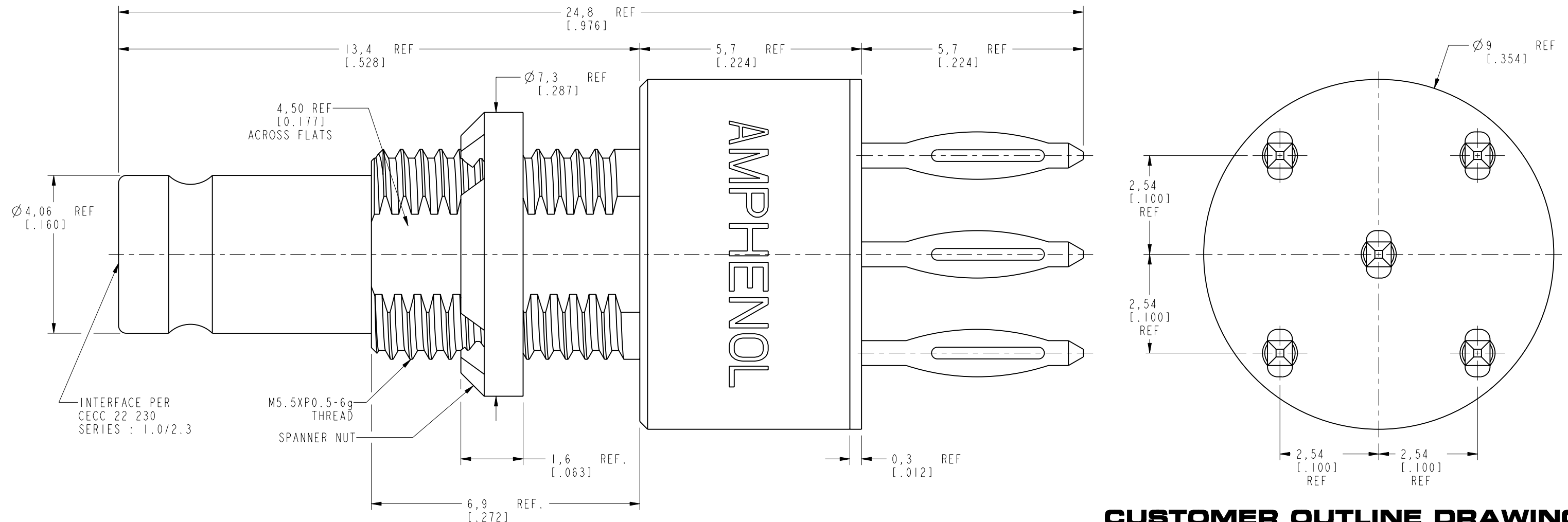

CUSTOMER OUTLINE DRAWING

ALL OTHER SHEETS ARE FOR INTERNAL USE ONLY

UNLESS OTHERWISE SPECIFIED, DIMENSIONS ARE IN METRIC AND TOLERANCES ARE: <0.5mm 0.5 - 6mm 6 - 30mm 30 - 120mm ANGLES ± 0.05mm ±0.1mm ±0.2mm ± 0.3mm ±1°	MATERIAL SEE NOTES	DRAWN STAR	DATE 29-Oct-15	TITLE 1.0/2.3 STR BHD JACK PCB RECEPTACLE		Amphenol RF www.amphenolrf.com	
NOTICE - These drawings, specifications, or other data (1) are, and remain the property of Amphenol corp. (2) must be returned upon request; and (3) are confidential and not to be disclosed to any person other than those to whom they are given by Amphenol Corp. the furnishing of these drawings, specifications, or other data by Amphenol Corp., or to any other person to anyone for any purpose is not to be regarded by implication or otherwise in any manner licensing, granting rights to permitting such holder or any other person to manufacture, use or sell any product, process or design, patented or otherwise, that may in any way be related to or disclosed by said drawings, specifications, or other data.		ENGINEER T. AUBIN	DATE 14-Sep-00				
REFERENCE EAR #		APPROVED S. HSIEH	DATE 29-Oct-15			SCALE: 6.0:1.0 SHEET 2 OF 2	ITEM NO. 3D-811-03
CONFIGURATION LEVEL: In Work		CAD FILE	DWG SIZE B		REV E	PART NO. 102-811-03	
FINISH							