

REV.	DATE	DESCRIPTION
A	11/04/03	UPDATE CONTACT PIN AND MOUNT POSTS

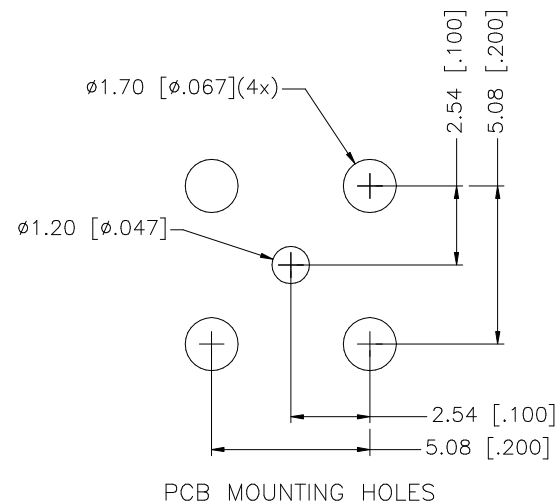
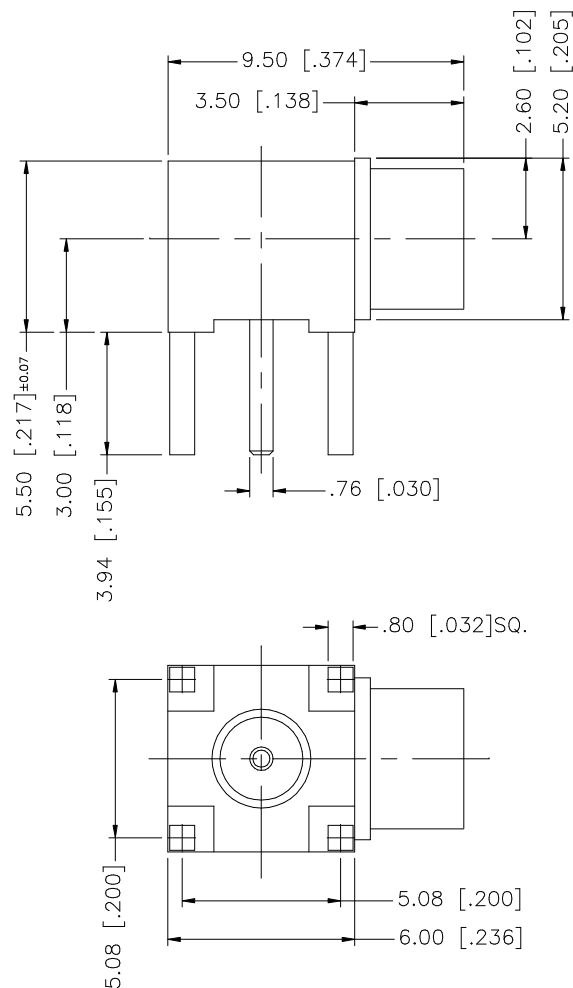

					<div>UNLESS OTHERWISE SPECIFIED DIMENSIONS ARE IN MILLIMETERS. DIMENSIONS IN [ ] ARE IN INCHES AND FOR CUSTOMER REFERENCE ONLY.</div> <div>UNLESS OTHERWISE SPECIFIED TOLERANCES FOR MILLIMETERS ARE: 0.5 – 8mm ± 0.20mm 8 – 30mm ± 0.40mm 30 – 120mm ± 0.50mm</div> <div>UNLESS OTHERWISE SPECIFIED TOLERANCES FOR INCHES ARE: .020 – .315 = ± 0.007” .315 – 1.180 = ± 0.015” 1.180 – 4.724 = ± 0.020”</div> <div>DO NOT SCALE DRAWING</div>	APPROVALS		DATE		<div>Amphenol Connex</div>						
8						DRAWN	G.R.S.	11/04/03								
7						CHECKED				PART DESCRIPTION  MCX R/A P.C. BOARD RECEPTACLE						
6						ISSUED										
5						SHEET	1 OF 1				PART NO.  252129-75-10					
4																
3	CONTACT PIN	BER. COPPER	GOLD	1					CAD FILE		DWG. NO. 252129-75-10.DWG					
2	INSULATOR	TEFLON	NATURAL	1					C:/252/252129-75-10.DWG							REV. A
1	BODY	BRASS	GOLD	1												
	DESCRIPTION	MATERIAL	FINISH	QTY												