

REV.	DATE	ECR NO.	DESCRIPTION
NC	02/13/97	-	INITIAL RELEASE
A	08/29/08	-	REVISE DRAWING FORMAT

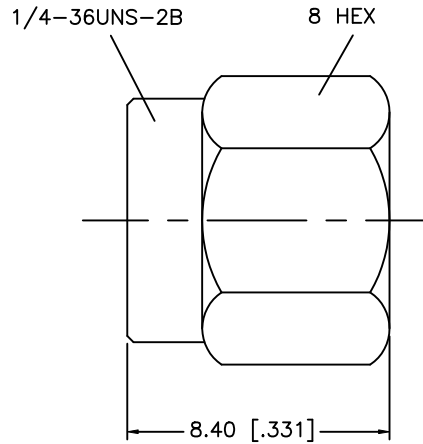

8				<small>UNLESS OTHERWISE SPECIFIED DIMENSIONS ARE IN MILLIMETERS. DIMENSIONS IN [] ARE IN INCHES AND FOR CUSTOMER REFERENCE ONLY.</small> <small>UNLESS OTHERWISE SPECIFIED TOLERANCES FOR MILLIMETERS ARE:</small> 0.5 - 8mm ± 0.20mm 8 - 30mm ± 0.40mm 30 - 120mm ± 0.50mm <small>UNLESS OTHERWISE SPECIFIED TOLERANCES FOR INCHES ARE:</small> .020 - .315 = ± 0.007" .315 - 1.180 = ± 0.015" 1.180 - 4.724 = ± 0.020" DO NOT SCALE DRAWING	APPROVALS	DATE	<h1 style="color: blue;">Amphenol Connex</h1>				
7					DRAWN	GRS					08/29/08
6					CHECKED			PART NO. 202112SS			
5					ISSUED						
4					SHEET	1 OF 1		REV. A SIZE A SCALE NA			
3											
2	GASKET	SILICONE	RED		1						
1	BODY	STAINLESS STEEL	PASSIVATED S.S.		1						
DESCRIPTION MATERIAL FINISH QTY				CAD FILE		C:/202/202112SS.DWG					