

REV.	DATE	DESCRIPTION
A	01/10/04	UPDATE DRAWING FORMAT

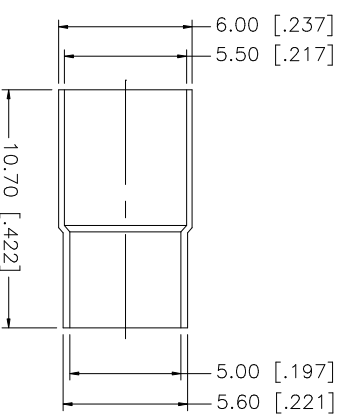
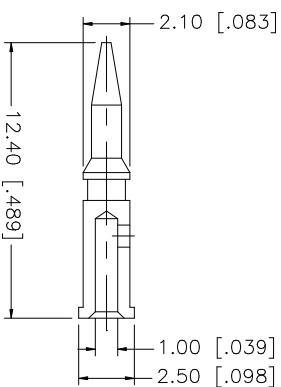
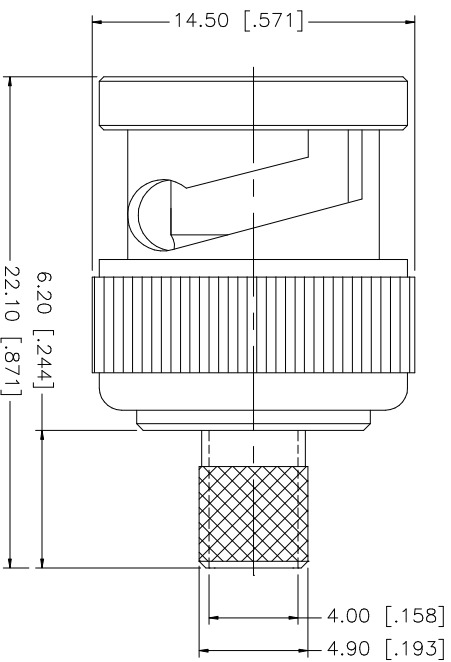
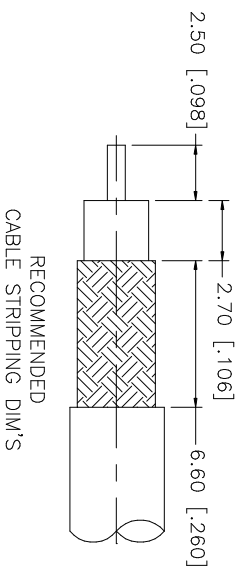

<div>Amphenol Connex</div>									
		PART DESCRIPTION		DWG. NO.		REV.		SCALE	
		BNC CRIMP PLUG (FOR 200 MHZ VIDEO CABLE)		112490-10.DWG		A		NA	
		PART NO.		112490-10					
		SHEET 1 OF 1							
		DRAWN		G.R.S.		01/10/04		DATE	
		CHECKED						APPROVALS	
		ISSUED							
		DO NOT SCALE DRAWING		C/D FILE		C:/112/112490-10.DWG			
		UNLESS OTHERWISE SPECIFIED DIMENSIONS ARE IN MILLIMETERS UNLESS DIMENSIONS IN INCHES ARE FOR CUSTOMER REFERENCE ONLY.							
		TOLERANCES FOR MILLIMETERS ARE:							
		0.5 - 8mm ± 0.20mm							
		8 - 30mm ± 0.40mm							
		30 - 120mm ± 0.50mm							
		UNLESS OTHERWISE SPECIFIED TOLERANCES FOR INCHES ARE:							
		.020 - .315 ± 0.007"							
		.315 - 1.180 ± 0.015"							
		1.180 - 4.724 ± 0.020"							
		QTY							
		FINISH							
		MATERIAL							
		DESCRIPTION							
		BODY							
		BRASS							
		NICKEL							
		NATURAL							
		TEFLON							
		BRASS							
		1							
		CONTACT PIN							
		BRASS							
		GOLD							
		NICKEL							
		COPPER							
		1							
		FERRULE							
		3							
		5							
		6							
		7							
		8							