

NOTES:

REFERENCE STANDARD IEC60169-4

I. ELECTRIC PERFORMANCE

- IMPEDANCE (Ω) : 50±2
- FREQUENCY RANGE : DC - 3.7GHz
- VSWR : ≤ 1.06
- INSERTION LOSS(dB)@ (2GHz) : < 0.05
- PIM(dBc) : ≤-160 (2x43 dBm)
- INSULATION RESISTANCE ($M\Omega$) : >10000
- WORKING VOLTAGE (V) : 2700
- CONDUCTOR RESISTANCE ($m\Omega$) : OUTER CONDUCTOR <0.2
INNER CONDUCTOR <0.8

II. MECHANICAL PERFORMANCE

- NUT TORQUE : 25N.m
- (NUT) WHORL PULL : 1000Nm
- TENSILE FORCE (CABLE-CONNECTOR) : 500N
- TORSION (CABLE-CONNECTOR) : 5N.m

III. ENVIRONMENT

- TEMP RANGE : -40 °C ~+85 °C
- THERMAL SHOCK : US MIL-STD 202,Meth.107,Cond.B
- VIBRATION : US MIL-STD 202,Meth.204,Cond.B
- SHOCK : US MIL-STD 202,Meth.213,Cond.I
- WEATHER STANDARD : IEC 68 40 /085/21
- WEATHER PROOFING STANDARD :IP68

IV. ASSEMBLY: INNER AND OUTER CONDUCTOR INSTALLED

V. ROHS COMPLIANT.

272FPH5

DRAWING NO.

THIRD ANGLE PROJ.



REV

NC

A

B

REVISIONS

DESCRIPTION

RELEASE TO MFG.

UPDATED DRAWING

MODIFY ELECTRICAL SPECIFICATIONS,CORRECT BOM

DATE

31-Oct-06

20-Aug-12

25-Mar-13

ECO

--

2360

2461

APPR

MG

MB

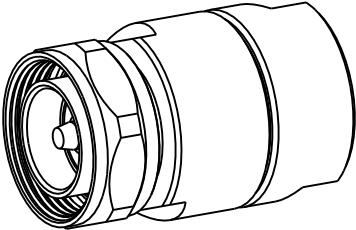

SCALE 0.750

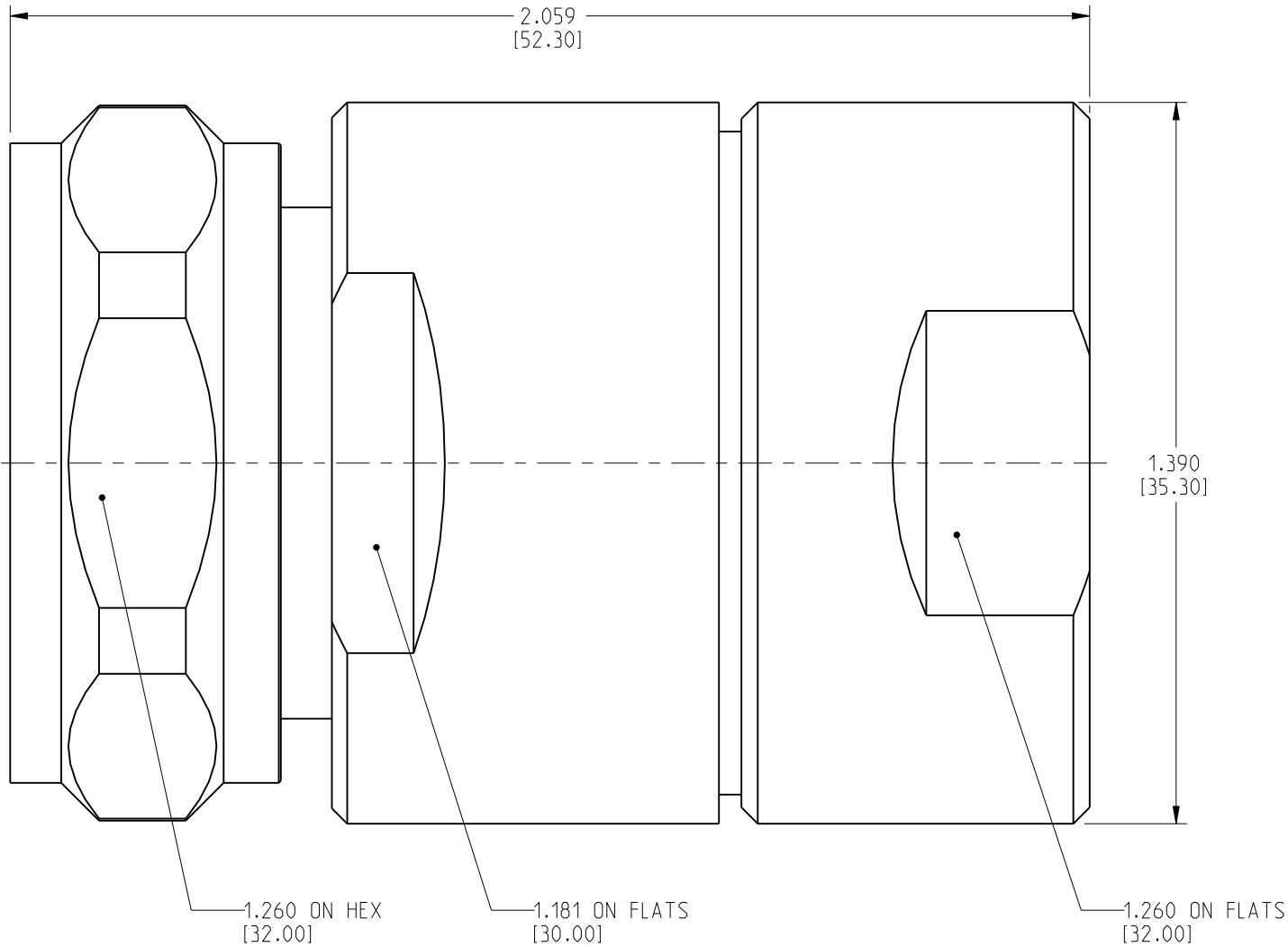

5	NUT	BRASS	NICKEL
4	INSULATOR	TPX	NATURAL
3	O-RING	SILICONE RUBBER	
2	OUTER CONDUCTOR	BRASS	WHITE BRONZE
1	INNER CONDUCTOR	BRASS	SILVER
S.NO	DESCRIPTION	MATERIAL	FINISH

UNLESS OTHERWISE SPECIFIED, DIMENSIONS ARE IN INCHES AND TOLERANCES ARE:
2 PLACE DECIMAL 3 PLACE DECIMAL ANGLES
±.015 (0,381 mm) ±.005 (0,127 mm) ± 1°

NOTICE - These drawings, specifications, or other data (1) are, and remain the property of Amphenol Corp. (2) must be returned upon request; and (3) are confidential and not to be disclosed to any person other than those to whom they are given by Amphenol Corp. The furnishing of these drawings, specifications, or other data by Amphenol Corp., or to any other person to anyone for any purpose is not to be regarded by implication or otherwise in any manner licensing, granting rights or permitting such holder or any other person to manufacture, use or sell any product, process or design, patented or otherwise, that may in any way be related to or disclosed by said drawings, specifications, or other data.

MATERIAL

SEE TABLE

REFERENCE

DRAWN

GOPI M

ENGINEER

GOPI M

APPROVED

CAD FILE

DATE

25-Mar-13

DATE

25-Mar-13

DATE

TITLE

7/16 STRAIGHT PLUG
FOR 7/8" HELICAL
(FSJ) CABLE

Amphenol
Connex

SCALE: 3.0:1

SHEET 1 OF 1

DWG SIZE

B

DRAWING NO.

272FPH5

REV

B