

NOTES:

1. MATERIALS AND FINISHES:  
 BODY - BRASS, NICKEL PLATING  
 FRONT BODY - BeCu, NICKEL PLATING  
 CONTACT - BeCu, GOLD PLATING  
 OUTER CONTACT - NICKEL COPPER ALLOY, NICKEL PLATING  
 INSULATOR - PEEK, NATURAL  
 PLASTIC SHEILD - PEEK, NATURAL
2. ELECTRICAL:  
 A. IMPEDANCE: 75 OHM  
 B. FREQUENCY RANGE: DC- 6 GHz  
 C. VSWR (RETURN LOSS): 1.06 (-30.00 dB), MAX.  
 D. DIELECTRIC WITHSTANDING VOLTAGE: 1000 VRMS, MIN.
3. MECHANICAL:  
 A. DURABILITY: 500 CYCLES MIN.  
 B. TEMPERATURE RANGE: -40°C TO 140°C
4. PACKAGING:  
 A. QUANTITY: SINGLE PACK  
 B. MARKING: PACKAGING TO BE MARKED  
 "AMPHENOL RF, AD-NDXJNDXJ-1 & DATE CODE"

REVISIONS				
REV	DESCRIPTION	DATE	ECN	BY
1	PROTOTYPE RELEASE	02-AUG-21	----	TL

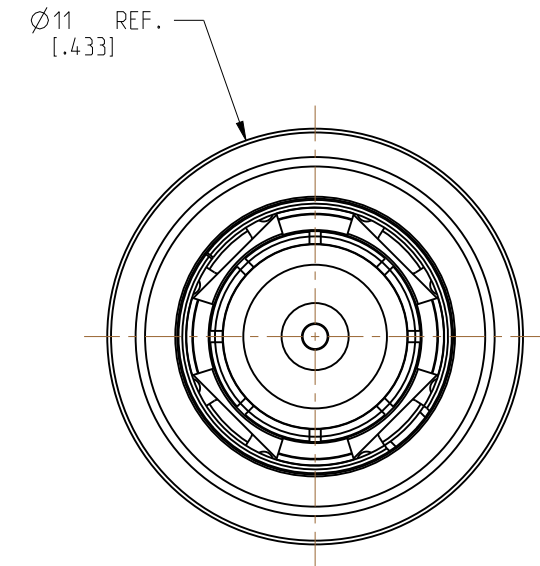
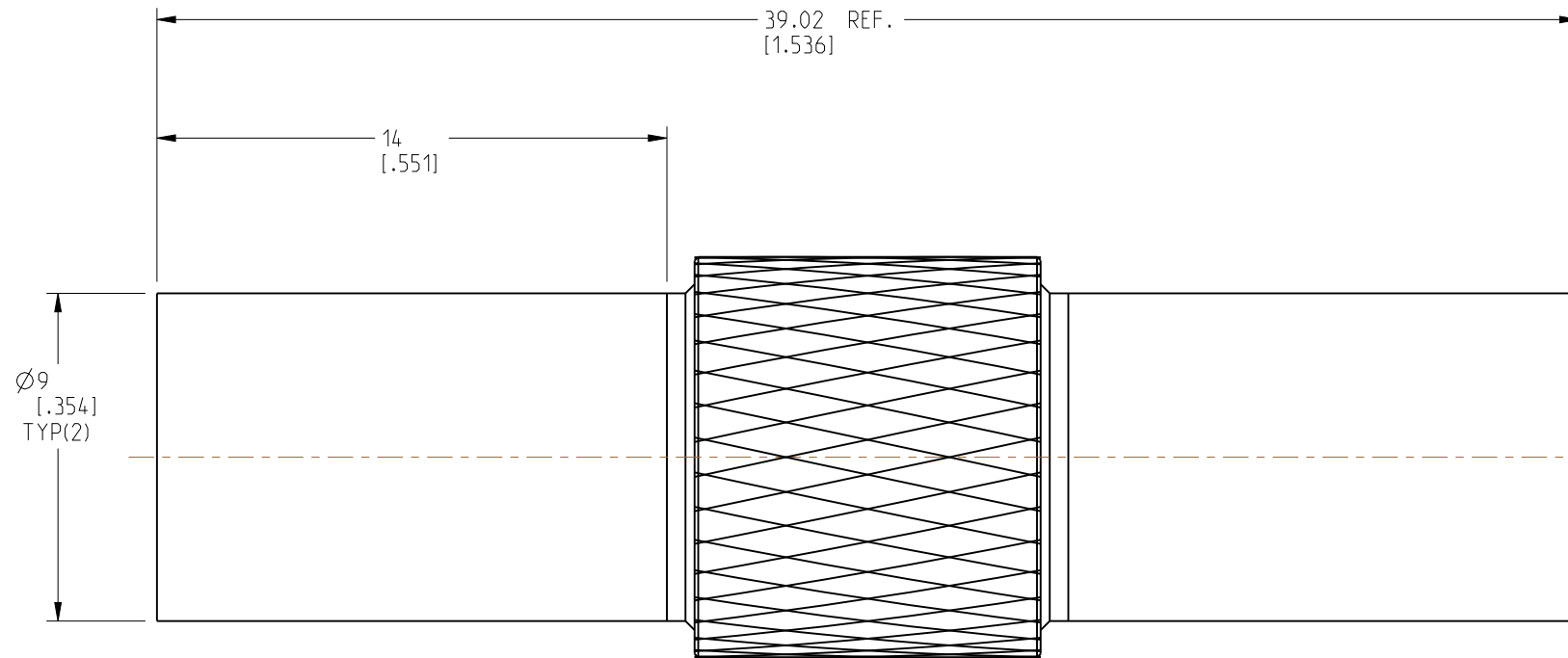
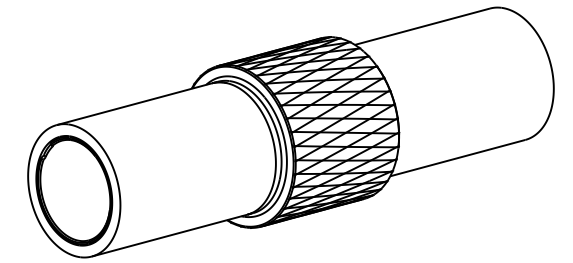

**CUSTOMER OUTLINE DRAWING**

ALL OTHER SHEETS ARE FOR INTERNAL USE ONLY

NOTICE: These drawings, specifications, or other data (1) are, and remain the property of Amphenol corp. (2) must be returned upon request; and (3) are confidential and not to be disclosed to any person other than those to whom they are given by Amphenol Corp. The furnishing of these drawings, specifications, or other data by Amphenol Corp., or to any other person to anyone for any purpose is not to be regarded by implication or otherwise in any manner licensing, granting rights to permitting such holder or any other person to manufacture, use or sell any product, process or design, patented or otherwise, that may in any way be related to or disclosed by said drawings, specifications, or other data.			UNLESS OTHERWISE SPECIFIED DIMENSIONS ARE METRIC (INCHES) AND TOLERANCES ARE: <0.5mm = ±0.05mm [ $<0.020 = \pm 0.002$ ] >0.5 - 6mm = ±0.1mm [ $>0.020 - 0.236 = \pm 0.004$ ] >6.00 - 30mm = ±0.2mm [ $>0.236 - 1.181 = \pm 0.008$ ] >30.00 - 120mm = ±0.3mm [ $>1.181 - 4.725 = \pm 0.012$ ]			MATERIAL SEE NOTE 1		TITLE NDX JACK TO NDX JACK ADAPTER		<b>Amphenol RF</b>	
THIRD ANGLE PROJ.			REFERENCE NDX-JS-PCT-3		EAR# 9849		ANGLES = ±1°		ENGR.1 T.LIPKIN		
					ENGR.2 M.ZHANG		DATE 02-AUG-21		SHEET NO. 2 OF 2		
							SCALE: 5.0:1.0		SIZE B		
									DRAWING NO. AD-NDXJNDXJ-1 ITEM NO. AD-NDXJNDXJ-1 PART NO. AD-NDXJNDXJ-1		
									REV 1		